

FEATURES

- PVC-U fittings for the PVC pipe union.
- Material: PVC-U.
- Injection moulding.
- Density: 1,4 g/cm³.
- Color: grey RAL 7024.
- Dimensions: socket fittings D16 to D400 and threaded fittings from 1/4" to 4".
- Dimensions:
 - Socket fittings according to EN 1452-3.
 - Threaded fittings according to ISO 7/1.
- For tubes according to EN 1452-2.
- Socket fittings: we recommend solvent cement for PVC-U.
- Threaded fittings: in order to guarantee the watertightness, PTFE thread-wrap tape must be used. In PVC-U metal unions, use PVC-U as the male.

CARACTERÍSTICAS

- Accesorios en PVC-U para unión de tuberías de PVC.
- Moldeo por inyección.
- Densidad: 1,4 g/cm³.
- Color: gris RAL 7024.
- Dimensiones: accesorios encolar de D16 hasta D400 y accesorios roscar de 1/4" a 4".
- Dimensiones:
 - Accesorios encolar según la norma EN 1452-3.
 - Accesorios roscados según la norma ISO 7/1.
- Para tubos según norma EN 1452-2.
- Accesorios encolar: recomendamos el uso de cola para PVC-U.
- Accesorios roscados: para garantizar la estanqueidad sólo es admisible el uso de cinta de PTFE. En uniones PVC-U-metal, el macho debe ser el PVC-U.

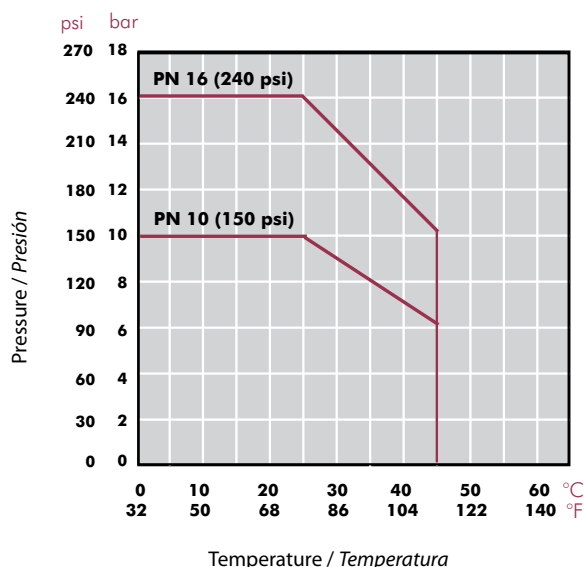

FIG.	Details	Detalles
1	Logo, material, dimensions, PN	Logo, material, dimensiones, PN
2	European standard, N (Aenor), Kiwa o NF (Afnor)	Norma europea, N (Aenor), Kiwa o NF (Afnor)
3	Marked at 45°	Marcaje a 45°

TECHNICAL CHARACTERISTICS
CARACTERÍSTICAS TÉCNICAS

Unions Uniones	Sizes Medidas	Working pressure at 20°C Presión de servicio a 20°C
Solvent socket / Encolar	D16 - D140	PN 16 (240 psi)
Solvent socket / Encolar	D160 - D315	PN10 (150 psi)
Threaded / Roscar	½" - 4"	PN 10 (150 psi)
Threaded reinforced / Roscar reforzado	½" - 4"	PN 16 (240 psi)

PRESSURE / TEMPERATURE GRAPH
DIAGRAMA PRESIÓN / TEMPERATURA



Life: 50 years
Hydrostatic maximum pressure a component may withstand in continuous service (without overpressure)

Vida útil: 50 años
Presión hidrostática máxima que un componente es capaz de soportar en servicio continuo (sin sobrepresión)

TOLERANCE CHART
TABLA TOLERANCIAS

D	DN	Minimum diameter Diámetro mínimo	Maximum diameter Diámetro máximo
16	10	16.1	16.3
20	15	20.1	20.3
25	20	25.1	25.3
32	25	32.1	32.3
40	32	40.1	40.3
50	40	50.1	50.3
63	50	63.1	63.3
75	65	75.1	75.3
90	80	90.1	90.3
110	100	110.1	110.4
125	110	125.1	125.4
140	125	140.2	140.5
160	150	160.2	160.5
200	175	200.2	200.6
225	200	225.3	225.7
250	225	250.3	250.8
315	300	315.4	316.0

PVC-U ELBOWS CODOS PVC-U

UP. 01. SF - 90° ELBOW

90° elbow

- Female solvent socket
- Metric series

Codo 90°

- Encolar hembra
- Serie métrica

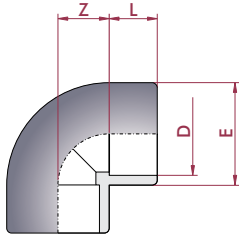

D	DN	PN	REF.	CODE
16	10	16	05 01 016 ³	11655
20	15	16	05 01 020 ¹²³	01712
25	20	16	05 01 025 ¹²³	01713
32	25	16	05 01 032 ²³	01714
40	32	16	05 01 040 ²³	01715
50	40	16	05 01 050 ¹²³	01716
63	50	16	05 01 063 ²³	01717
75	65	16	05 01 075 ²³	01718
90	80	16	05 01 090 ²³	01719
110	100	16	05 01 110 ³	01720
125	110	16	05 01 125 ³	01721
140	125	16	05 01 140 ³	01722
160	150	10	05 01 160 ³	01723
200	175	10	05 01 200 ³	01724
225	200	10	05 01 225 ³	01725
250	225	10	05 01 250	01726
315	300	10	05 01 315	01727
400	353	5	05 01 400 [*]	34807

L	Z	E
14	10	25
16	11	27
19	14	33
22	17	41
26	21	50
31	26	61
38	33	76
44	39	90
51	46	108
61	56	131
69	64	148
76	71	164
86	81	180
106	101	225
119	114	252
131	126	284
164	159	352
206	202	439

UP. 01. SFT - 90° ELBOW

90° adaptor elbow

- Female solvent socket & BSP female thread
- Metric series

Codo 90° mixto

- Encolar hembra y roscar hembra BSP
- Serie métrica

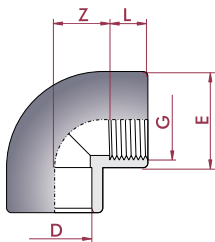

D x G	DN	PN	REF.	CODE
20 x 1/2"	15	10	05 01 420	01728
25 x 3/4"	20	10	05 01 425	01729
32 x 1"	25	10	05 01 432	01730
40 x 1 1/4"	32	10	05 01 440	01731
50 x 1 1/2"	40	10	05 01 450	01732
63 x 2"	50	10	05 01 463	01733
75 x 2 1/2"	65	10	05 01 475 [*]	22596
90 x 3"	80	10	05 01 490 [*]	22597
110 x 4"	100	10	05 01 510 [*]	22598

L	Z	E
14	11	28
16	14	34
19	17	43
20	21	54
20	26	63
24	33	78
44	40	89
51	48	106
61	58	129

UP. 01. SFTR - 90° REINFORCED ELBOW

90° adaptor reinforced elbow

- Female solvent socket & BSP female thread
- Reinforcement in stainless steel
- Metric series

Codo 90° mixto reforzado

- Encolar hembra y roscar hembra BSP
- Refuerzo en acero inoxidable
- Serie métrica

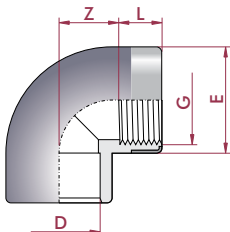

D x G	DN	PN	REF.	CODE
20 x 1/2"	15	16	05 01 820	01740
25 x 3/4"	20	16	05 01 825	01741
32 x 1"	25	16	05 01 832	01742
40 x 1 1/4"	32	16	05 01 840	01743
50 x 1 1/2"	40	16	05 01 850	01744
63 x 2"	50	16	05 01 863	01745

L	Z	E
14	11	28
16	14	34
19	17	43
20	21	54
20	26	63
24	33	78

UP. 01. FT - 90° ELBOW

90° elbow

- BSP female thread

Codo 90°

- Roscar hembra BSP

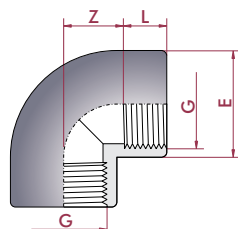

G	DN	PN	REF.	CODE
1/2"	15	10	05 01 620	01734
3/4"	20	10	05 01 625	01735
1"	25	10	05 01 632	01736
1 1/4"	32	10	05 01 640	01737
1 1/2"	40	10	05 01 650	01738
2"	50	10	05 01 663	01739
2 1/2"	65	10	05 01 675 [*]	22587
3"	80	10	05 01 690 [*]	22588
4"	100	10	05 01 710 [*]	22589

L	Z	E
14	11	28
16	14	34
19	17	43
20	21	54
20	26	63
24	33	78
30	54	89
33	66	106
39	80	129

* Distributed product
* Producto comercializado

¹ AFNOR
² KIWA
³ AENOR

UP. 29. SFG - 90° REDUCING ELBOW

90° reducing elbow

- Female solvent socket
- Metric series

Codo 90° reducido

- Encolar hembra
- Serie métrica

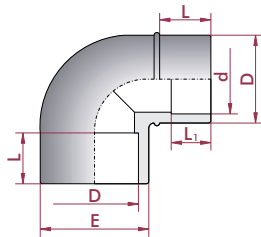

D x D - d	DN	PN	REF.	CODE
50 x 50 - 40	32	16	05 29 050	02237
63 x 63 - 50	40	16	05 29 063	02238

L	L ₁	E
31	26	61
38	31	76

UP. 29. SMT - 90° ELBOW

90° elbow

- Female solvent socket & BSP male thread
- Metric series

Codo 90°

- Encolar hembra y rosar macho BSP
- Serie métrica

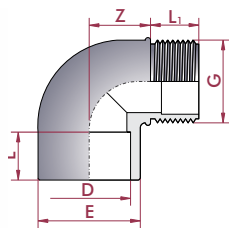

D x G	DN	PN	REF.	CODE
50 x 1 1/2"	40	10	05 29 450	02239
63 x 2"	50	10	05 29 463	02240

L ₁	L	E	Z
21	31	61	38
25	38	76	47

UP. 02. SF - 45° ELBOW

45° elbow

- Female solvent socket
- Metric series

Codo 45°

- Encolar hembra
- Serie métrica

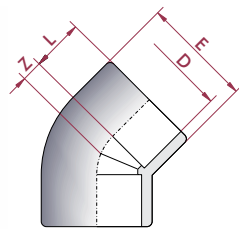

D	DN	PN	REF.	CODE
16	10	16	05 02 016 ³	16307
20	15	16	05 02 020 ¹²³	01746
25	20	16	05 02 025 ¹²³	01747
32	25	16	05 02 032 ¹²³	01748
40	32	16	05 02 040 ¹²³	01749
50	40	16	05 02 050 ²³	01750
63	50	16	05 02 063 ²³	01751
75	65	16	05 02 075 ²³	01752
90	80	16	05 02 090 ²³	01753
110	100	16	05 02 110 ³	01754
125	110	16	05 02 125 ³	01755
140	125	16	05 02 140 ³	01756
160	150	10	05 02 160 ³	01757
200	175	10	05 02 200 ³	01758
225	200	10	05 02 225 ³	01759
250	225	10	05 02 250 ³	01760
315	300	10	05 02 315 ³	01761
400	353	5	05 02 400 [*]	34808

L	Z	E
14	5	22
16	5	28
19	6	35
22	8	43
26	10	52
31	12	58
38	14	76
44	17	93
51	20	109
61	24	133
69	27	148
76	30	164
86	34	180
106	43	225
119	48	252
131	53	284
164	67	352
206	83	439

UP. 02. SFT - 45° ELBOW

45° adaptor elbow

- Female solvent socket & BSP female thread
- Metric series

Codo 45° mixto

- Encolar hembra y rosar hembra BSP
- Serie métrica

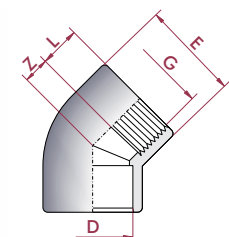

D x G	DN	PN	REF.	CODE
20 x 1/2"	15	10	05 02 420	01762
25 x 3/4"	20	10	05 02 425	01763
32 x 1"	25	10	05 02 432	01764
40 x 1 1/4"	32	10	05 02 440	01765
50 x 1 1/2"	40	10	05 02 450	01766
63 x 2"	50	10	05 02 463	01767
75 x 2 1/2"	65	10	05 02 475 [*]	22599
90 x 3"	80	10	05 02 490 [*]	22600
110 x 4"	100	10	05 02 510 [*]	22601

L	Z	E
14	5	28
16	6	34
19	8	43
20	10	54
20	12	63
24	14	78
44	18	89
51	21	106
61	25	128

^{*} Distributed product
^{*} Producto comercializado

¹ AFNOR
² KIWA
³ AENOR

UP. 02. SFTR - 45° REINFORCED ELBOW

45° adaptor reinforced elbow

- Female solvent socket & BSP female thread
- Reinforcement in stainless steel
- Metric series

Codo 45° mixto reforzado

- Encolar hembra y roscar hembra BSP
- Refuerzo en acero inoxidable
- Serie métrica

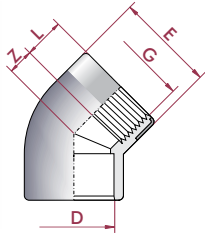

D x G	DN	PN	REF.	CODE
20 x 1/2"	15	16	05 02 820	01774
25 x 3/4"	20	16	05 02 825	01775
32 x 1"	25	16	05 02 832	01776
40 x 1 1/4"	32	16	05 02 840	01777
50 x 1 1/2"	40	16	05 02 850	01778
63 x 2"	50	16	05 02 863	01779

L	Z	E
14	5	28
16	6	34
19	8	43
20	10	54
20	12	63
24	14	78

UP. 02. FT - 45° ELBOW

45° elbow

- BSP female thread

Codo 45°

- Roscar hembra BSP

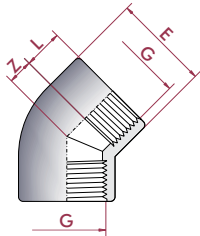

G	DN	PN	REF.	CODE
1/2"	15	10	05 02 620	01768
3/4"	20	10	05 02 625	01769
1"	25	10	05 02 632	01770
1 1/4"	32	10	05 02 640	01771
1 1/2"	40	10	05 02 650	01772
2"	50	10	05 02 663	01773
2 1/2"	65	10	05 02 675 *	22590
3"	80	10	05 02 690 *	22591
4"	100	10	05 02 710 *	22592

L	Z	E
14	5	28
16	6	34
19	8	43
20	10	54
20	12	63
24	14	78
30	32	89
34	39	106
40	47	129

UP. 30. SFG - 45° REDUCING ELBOW

45° reducing elbow

- Female and male solvent socket
- Metric series

Codo 45° reducido

- Encolar hembra y macho
- Serie métrica

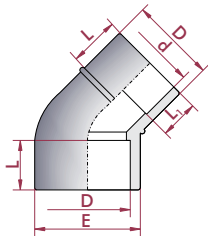

D x D - d	DN	PN	REF.	CODE
50 x 50 - 40	32	16	05 30 050	02241
63 x 63 - 50	40	16	05 30 063	02242

L	L ₁	E
31	26	61
38	31	76

* Distributed product

* Producto comercializado

PVC-U BEND
CURVAS PVC-U

UP. 35. SF - 45° BEND

- 45° bend**
- Female solvent socket
 - Metric series

- Curva 45°**
- Encolar hembra
 - Serie métrica

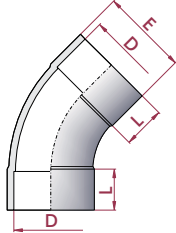

D	DN	PN	REF.	CODE
315	300	4	05 35 315 *	05348
400	353	4	05 35 400 *	05349

L	E
165	348
206	432

UP. 08. SF - 90° BEND

- 90° bend**
- Female solvent socket
 - Metric series

- Curva 90°**
- Encolar hembra
 - Serie métrica

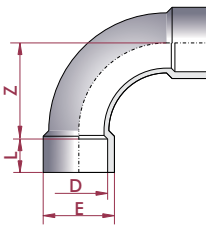

D	DN	PN	REF.	CODE
20	15	16	05 08 020 ³	01967
25	20	16	05 08 025 ³	01968
32	25	16	05 08 032 ³	01969
40	32	16	05 08 040 ³	01970
50	40	16	05 08 050 ³	01971
63	50	16	05 08 063 ³	01972
75	65	16	05 08 075 ³	01973
90	80	16	05 08 090 ³	05331
110	100	16	05 08 110 *	05332
125	110	10	05 08 125 *	05333
140	125	10	05 08 140 *	05334
160	150	10	05 08 160 *	05335
200	175	4	05 08 200 *	05336
225	200	4	05 08 225 *	05337
250	225	4	05 08 250 *	05338
315	300	4	05 08 315 *	05339
400	353	4	05 08 400 *	05340

L	Z	E
16	40	27
19	50	33
22	64	41
26	80	50
31	100	61
38	126	76
44	150	90
51	180	113
61	220	132
69	186	150
76	166	164
86	194	186
106	284	223
119	296	251
131	334	275
165	520	348
206	614	432

* Distributed product
* Producto comercializado

³ AENOR

PVC-U TEES

TÉS PVC-U

UP. 03. SF - 90° TEE

90° tee

- Female solvent socket
- Metric series

Té 90°

- Encolar hembra
- Serie métrica

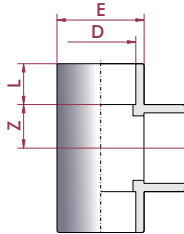

D	DN	PN	REF.	CODE
16	10	16	05 03 016 ³	16308
20	15	16	05 03 020 ¹²³	01780
25	20	16	05 03 025 ¹²³	01781
32	25	16	05 03 032 ¹²³	01782
40	32	16	05 03 040 ¹²³	01783
50	40	16	05 03 050 ¹²³	01784
63	50	16	05 03 063 ¹²³	01785
75	65	16	05 03 075 ²³	01786
90	80	16	05 03 090 ²³	01787
110	100	16	05 03 110 ³	01788
125	110	16	05 03 125 ³	01789
140	125	16	05 03 140 ³	01790
160	150	10	05 03 160 ³	01791
200	175	10	05 03 200 ³	01792
225	200	10	05 03 225 ³	01793
250	225	10	05 03 250 ³	01794
315	300	10	05 03 315 ³	01795
400	325	4	05 03 400 [*]	05328

L	Z	E
14	9	22
16	11	27
19	14	33
22	17	41
26	21	50
31	26	63
38	33	78
44	39	90
51	46	108
61	56	131
69	64	148
76	71	164
86	81	186
106	101	228
119	114	255
131	126	284
164	159	356
206	280	432

UP. 03. SFT - 90° TEE

90° adaptor tee

- Female solvent socket & BSP female thread
- Metric series

Té 90° mixta

- Encolar hembra y roscar hembra BSP
- Serie métrica

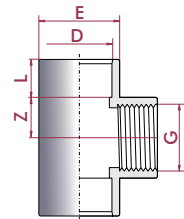

D x G	DN	PN	REF.	CODE
20 x 1/2"	15	10	05 03 420	01796
25 x 3/4"	20	10	05 03 425	01797
32 x 1"	25	10	05 03 432	01798
40 x 1 1/4"	32	10	05 03 440	01799
50 x 1 1/2"	40	10	05 03 450	01800
63 x 2"	50	10	05 03 463	01801
75 x 2 1/2"	65	10	05 03 475 [*]	22602
90 x 3"	80	10	05 03 490 [*]	22603
110 x 4"	100	10	05 03 510 [*]	22604

L	Z	E
14	11	28
16	14	34
19	17	43
20	21	54
20	26	63
24	33	78
44	39	89
51	47	106
61	57	129

UP. 03. SFTR - 90° REINFORCED TEE

90° adaptor reinforced tee

- Female solvent socket & BSP female thread
- Reinforcement in stainless steel
- Metric series

Té 90° mixta reforzada

- Encolar hembra y roscar hembra BSP
- Refuerzo en acero inoxidable
- Serie métrica

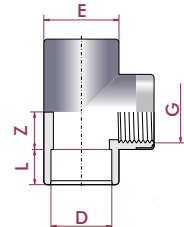

D x G	DN	PN	REF.	CODE
20 x 1/2"	15	16	05 03 820	01808
25 x 3/4"	20	16	05 03 825	01809
32 x 1"	25	16	05 03 832	01810
40 x 1 1/4"	32	16	05 03 840	01811
50 x 1 1/2"	40	16	05 03 850	01812
63 x 2"	50	16	05 03 863	01813

L	Z	E
14	11	28
16	14	34
19	17	43
20	21	54
20	26	63
24	33	78

UP. 03. FT - 90° TEE

90° tee

- BSP female thread

Té 90°

- Roscar hembra BSP

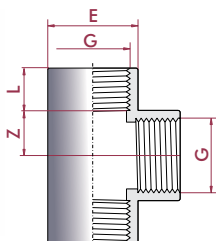

G	DN	PN	REF.	CODE
1/2"	15	10	05 03 620	01802
3/4"	20	10	05 03 625	01803
1"	25	10	05 03 632	01804
1 1/4"	32	10	05 03 640	01805
1 1/2"	40	10	05 03 650	01806
2"	50	10	05 03 663	01807
2 1/2"	65	10	05 03 675 [*]	22593
3"	80	10	05 03 690 [*]	22594
4"	100	10	05 03 710 [*]	22595

L	Z	E
14	11	28
16	14	34
19	17	43
20	21	54
20	26	63
24	33	78
30	53	89
34	65	106
40	79	129

* Distributed product
* Producto comercializado

¹ AFNOR
² KIWA
³ AENOR

UP. 04. SFG - 90° REDUCING TEE

90° reducing tee

- Female solvent socket
- Metric series

Té 90° reducida

- Encolar hembra
- Serie métrica

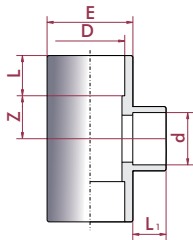

D x d	DN	PN	REF.	CODE
25 x 20	20 - 15	16	05 04 025	01814
32 x 25	25 - 20	16	05 04 032	01815
32 x 20	25 - 15	16	05 04 033	01816
40 x 32	32 - 25	16	05 04 040	01817
40 x 25	32 - 20	16	05 04 041	01818
40 x 20	32 - 15	16	05 04 042	01819
50 x 40	40 - 32	16	05 04 050	01820
50 x 32	40 - 25	16	05 04 051	01821
50 x 25	40 - 20	16	05 04 052	01822
50 x 20	40 - 15	16	05 04 053	01823
63 x 50	50 - 40	16	05 04 063	01824
63 x 40	50 - 32	16	05 04 064	01825
63 x 32	50 - 25	16	05 04 065	01826
63 x 25	50 - 20	16	05 04 066	01827
63 x 20	50 - 15	16	05 04 067	01828
75 x 63	65 - 50	16	05 04 075	01829
75 x 50	65 - 40	16	05 04 076	01830
75 x 40	65 - 32	16	05 04 077	01831
75 x 32	65 - 25	16	05 04 078	01832
90 x 75	80 - 65	16	05 04 090	01833
90 x 63	80 - 50	16	05 04 091	01834
90 x 50	80 - 40	16	05 04 092	01835
90 x 40	80 - 32	16	05 04 093	01836
110 x 90	100 - 80	16	05 04 110	01837
110 x 75	100 - 65	16	05 04 111	01838
110 x 63	100 - 50	16	05 04 112	01839
110 x 50	100 - 40	16	05 04 113	01840
125 x 110	110 - 100	16	05 04 125	01841
125 x 90	110 - 80	16	05 04 126	01842
125 x 75	110 - 65	16	05 04 127	01843
125 x 63	110 - 50	16	05 04 128	01844
140 x 125	125 - 110	16	05 04 140	01845
140 x 110	125 - 100	16	05 04 141	01846
140 x 90	125 - 80	16	05 04 142	01847
140 x 75	125 - 65	16	05 04 143	01848
160 x 140	150 - 125	10	05 04 160	07688
160 x 125	150 - 110	10	05 04 161	07689
160 x 110	150 - 100	10	05 04 162	07690
160 x 90	150 - 80	10	05 04 163	07691

L	L ₁	Z	E
19	16	14	33
22	19	17	41
22	16	17	41
26	22	21	50
26	19	21	50
26	16	21	50
31	26	26	61
31	22	26	61
31	19	26	61
31	16	26	61
38	31	33	76
38	26	33	76
38	22	33	76
38	19	33	76
38	16	33	76
44	38	39	90
44	31	39	90
44	26	39	90
44	22	39	90
51	44	46	108
51	38	46	108
51	31	46	108
51	26	46	108
61	51	56	131
61	44	56	131
61	38	56	131
61	31	56	131
69	61	64	149
69	51	64	149
69	44	64	149
69	38	64	149
76	69	71	162
76	61	71	162
76	51	71	162
76	44	71	162
86	76	81	186
86	69	81	186
86	61	81	186
86	41	81	187

UP. 04. SFTG - 90° REDUCING TEE
90° reducing tee

- Female solvent socket & BSP female thread
- Metric series

Té 90° reducida

- Encolar hembra y roscar hembra BSP
- Serie métrica

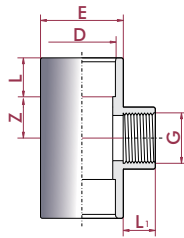

D x G	DN	PN	REF.	CODE
25 x 1/2"	20 - 15	10	05 04 425	01849
32 x 3/4"	25 - 20	10	05 04 432	01850
32 x 1/2"	25 - 15	10	05 04 433	01851
40 x 1"	32 - 25	10	05 04 440	01852
40 x 3/4"	32 - 20	10	05 04 441	01853
40 x 1/2"	32 - 15	10	05 04 442	01854
50 x 1 1/4"	40 - 32	10	05 04 450	01855
50 x 1"	40 - 25	10	05 04 451	01856
50 x 3/4"	40 - 20	10	05 04 452	01857
50 x 1/2"	40 - 15	10	05 04 453	01858
63 x 1 1/2"	50 - 40	10	05 04 463	01859
63 x 1 1/4"	50 - 32	10	05 04 464	01860
63 x 1"	50 - 25	10	05 04 465	01861
63 x 3/4"	50 - 20	10	05 04 466	01862
63 x 1/2"	50 - 15	10	05 04 467	01863
75 x 2"	65 - 50	10	05 04 475	01864
75 x 1 1/2"	65 - 40	10	05 04 476	01865
75 x 1 1/4"	65 - 32	10	05 04 477	01866
75 x 1"	65 - 25	10	05 04 478	01867
90 x 2 1/2"	80 - 65	10	05 04 490	01868
90 x 2"	80 - 50	10	05 04 491	01869
90 x 1 1/2"	80 - 40	10	05 04 492	01870
90 x 1 1/4"	80 - 32	10	05 04 493	01871

L	L ₁	Z	E
19	14	14	33
22	16	17	41
22	14	17	41
26	19	21	50
26	16	21	50
26	14	21	50
31	20	26	61
31	19	26	61
31	16	26	61
31	14	26	61
38	20	33	76
38	20	33	76
38	19	33	76
38	16	33	76
38	14	33	76
44	24	39	90
44	20	39	90
44	20	39	90
44	19	39	90
51	44	46	108
51	24	46	108
51	20	46	108
51	20	46	108

UP. 36. SF - 45° TEE
45° tee

- Female solvent socket
- Metric series

Té 45°

- Encolar hembra
- Serie métrica

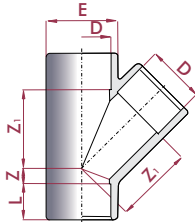

D	DN	PN	REF.	CODE
20	15	16	05 36 020 *	22583
25	20	16	05 36 025 *	22584
32	25	16	05 36 032 *	22585
40	32	16	05 36 040	22586
50	40	10	05 36 050 ³	20155
63	50	10	05 36 063 ³	20156
75	65	10	05 36 075 *	32804
90	80	10	05 36 090 *	32805
110	100	10	05 36 110 *	32806

L	Z	Z ₁	E
16	7	29	28
19	7	36	34
22	8	44	42
26	10	54	51
31	13	67	61
38	15	83	76
44	18	101	91
51	20	122	106
61	27	149	133

**PVC-U CROSSES
CRUCES PVC-U**
UP. 28. SF - CROSS
Cross

- Female solvent socket
- Metric series

Cruz

- Encolar hembra
- Serie métrica

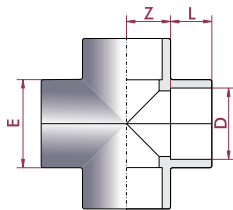

D	DN	PN	REF.	CODE
20	15	16	05 28 020	20143
25	20	16	05 28 025	20144
32	25	16	05 28 032	20145
40	32	16	05 28 040	20146
50	40	16	05 28 050	02235
63	50	16	05 28 063	02236
75	65	16	05 28 075 *	27958
90	80	16	05 28 090 *	22581
110	100	16	05 28 110 *	22582

L	Z	E
16	11	29
19	14	35
22	17	43
26	21	52
31	26	63
38	33	79
42	39	92
51	46	106
61	56	130

* Distributed product
* Producto comercializado

³ AENOR

PVC-U SOCKETS MANGUITOS UNIÓN PVC-U

UP. 05. SF - SOCKET

Socket

- Female solvent socket
- Metric series

Manguito unión

- Encolar hembra
- Serie métrica

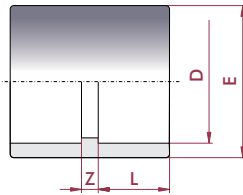

D	DN	PN	REF.	CODE
16	10	16	05 05 016 ³	16309
20	15	16	05 05 020 ¹²³	01872
25	20	16	05 05 025 ¹²³	01873
32	25	16	05 05 032 ¹²³	01874
40	32	16	05 05 040 ¹²³	01875
50	40	16	05 05 050 ¹²³	01876
63	50	16	05 05 063 ¹²³	01877
75	65	16	05 05 075 ¹²³	01878
90	80	16	05 05 090 ¹²³	01879
110	100	16	05 05 110 ¹³	01880
125	110	16	05 05 125 ¹³	01881
140	125	16	05 05 140 ¹³	01882
160	150	10	05 05 160 ¹³	01883
200	175	10	05 05 200 ³	01884
225	200	10	05 05 225 ³	01885
250	225	10	05 05 250 ³	01886
315	300	10	05 05 315 ³	01887
400	375	6	05 05 400*	05329

L	Z	E
14	3	22
16	3	27
19	3	33
22	3	41
26	3	50
31	3	61
38	3	75
44	4	90
51	5	108
61	6	129
69	7	148
76	9	164
86	9	180
106	10	225
119	10	252
131	12	280
164	12	352
206	12	432

UP. 05. SFT - SOCKET

Adaptor socket

- Female solvent socket & BSP female thread
- Metric series

Manguito unión mixto

- Encolar hembra y roscar hembra BSP
- Serie métrica

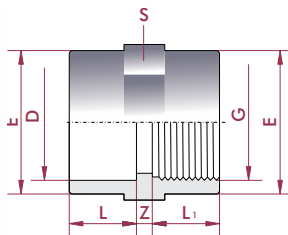

D x G	DN	PN	REF.	CODE
16 x 3/8"	12	10	05 05 416	01888
20 x 1/2"	15	10	05 05 420	01889
25 x 3/4"	20	10	05 05 425	01890
32 x 1"	25	10	05 05 432	01891
40 x 1 1/4"	32	10	05 05 440	01892
50 x 1 1/2"	40	10	05 05 450	01893
63 x 2"	50	10	05 05 463	01894
75 x 2 1/2"	65	10	05 05 475	01895
90 x 3"	80	10	05 05 490	01896
110 x 4"	90	10	05 05 510	01897

L	L ₁	Z	E	S
14	14	3	22	22
16	14	3	28	27
19	16	3	34	33
22	19	3	43	41
26	20	3	54	50
31	20	3	63	61
38	24	3	78	75
44	44	4	90	90
51	51	6	108	108
61	61	6	135	135

UP. 05. SFTR - SOCKET REINFORCED

Adaptor socket reinforced

- Female solvent socket & BSP female thread
- Reinforcement in stainless steel
- Metric series

Manguito unión mixto reforzado

- Encolar hembra y roscar hembra BSP
- Refuerzo en acero inoxidable
- Serie métrica

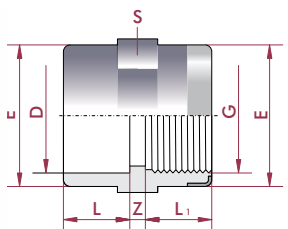

D x G	DN	PN	REF.	CODE
20 x 1/2"	15	16	05 05 820	01908
25 x 3/4"	20	16	05 05 825	01909
32 x 1"	25	16	05 05 832	01910
40 x 1 1/4"	32	16	05 05 840	01911
50 x 1 1/2"	40	16	05 05 850	01912
63 x 2"	50	16	05 05 863	01913

L	L ₁	Z	E	S
16	14	3	28	27
19	16	3	34	33
22	19	3	43	41
26	20	3	54	50
31	20	3	63	61
38	24	3	78	75

UP. 05. FT - SOCKET

Threaded adaptor socket

- BSP female thread

Manguito unión doble rosca

- Roscar hembra BSP

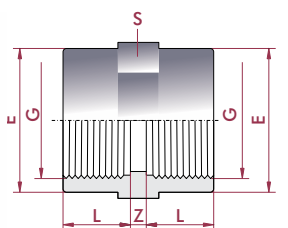

G	DN	PN	REF.	CODE
3/8"	10	10	05 05 616	01898
1/2"	15	10	05 05 620	01899
3/4"	20	10	05 05 625	01900
1"	25	10	05 05 632	01901
1 1/4"	32	10	05 05 640	01902
1 1/2"	40	10	05 05 650	01903
2"	50	10	05 05 663	01904
2 1/2"	65	10	05 05 675	01905
3"	80	10	05 05 690	01906
4"	100	10	05 05 710	01907

L	Z	E	S
14	3	22	22
14	3	27	28
16	3	33	34
19	3	41	43
20	3	50	54
20	3	61	63
24	3	75	78
44	4	90	90
51	6	108	108
61	6	135	135

* Distributed product
* Producto comercializado

¹ AFNOR
² KIWA
³ AENOR

PVC-U REDUCERS REDUCCIONES PVC-U

UP. 06. SMF - REDUCING BUSH

Reducing bush

- Male x female solvent socket
- Metric series

Casquillo reducción

- Encolar macho x hembra
- Serie métrica

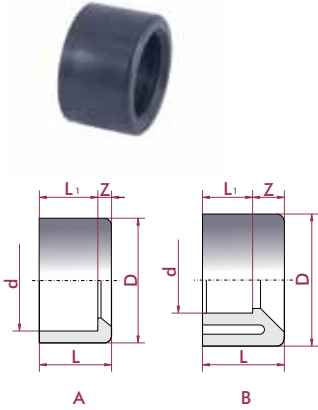

D x d	DN	PN	REF.	CODE	L	L ₁	Z	Mod.
20 x 16	10	16	05 06 020 ³	01914	16	14	2	A
25 x 20	15	16	05 06 025 ²³	01915	19	16	3	A
32 x 25	20	16	05 06 032 ²³	01916	22	19	3	A
32 x 20	15	16	05 06 033 ³	01917	22	16	6	A
40 x 32	25	16	05 06 040 ²³	01918	26	22	4	A
40 x 25	20	16	05 06 041 ³	01919	26	19	7	A
40 x 20	15	16	05 06 042 ³	01920	26	16	10	B
50 x 40	32	16	05 06 050 ²³	01921	31	26	5	A
50 x 32	25	16	05 06 051 ³	01922	31	22	9	B
50 x 25	20	16	05 06 052 ³	01923	31	19	12	B
50 x 20	15	16	05 06 053 ³	01924	31	16	15	B
63 x 50	40	16	05 06 063 ²³	01925	38	31	7	A
63 x 40	32	16	05 06 064 ³	01926	38	26	12	B
63 x 32	25	16	05 06 065 ³	01927	38	22	16	B
75 x 63	50	16	05 06 075 ²³	01928	44	38	6	A
75 x 50	40	16	05 06 076 ³	18685	44	31	13	B
75 x 40	32	16	05 06 077 ³	18686	44	26	18	B
90 x 75	65	16	05 06 090 ²³	01929	51	44	7	A
90 x 63	50	16	05 06 091 ³	18687	51	38	13	B
90 x 50	40	16	05 06 092 ³	18688	51	31	20	B
110 x 90	80	16	05 06 110 ³	01930	61	51	10	A
110 x 75	65	16	05 06 111 ³	18689	61	44	17	B
110 x 63	50	16	05 06 112 ³	18690	61	38	23	B
125 x 110	100	16	05 06 125 ³	01931	69	61	8	A
125 x 90	80	16	05 06 126 ³	18691	69	51	18	B
125 x 75	65	16	05 06 127 ³	20142	69	44	25	B
140 x 125	110	16	05 06 140 ³	01932	76	69	8	A
140 x 110	100	16	05 06 141 ³	18692	76	61	15	B
160 x 140	125	10	05 06 160 ³	01933	86	76	10	A
160 x 110	100	10	05 06 162 ³	18693	86	61	25	B
200 x 180	160	10	05 06 199 ³	01934	106	96	10	A
200 x 160	150	10	05 06 200 ³	01935	106	86	20	B
225 x 200	175	10	05 06 225 ³	01936	119	106	13	A
225 x 160	150	10	05 06 226 ³	01937	119	86	33	B
250 x 225	200	10	05 06 250 ³	01938	131	119	12	A
250 x 200	175	10	05 06 251 ³	01939	131	106	25	B
315 x 280	250	6	05 06 315	10093				
315 x 250	225	6	05 06 316 [*]	01940	164	131	33	B
315 x 225	200	6	05 06 317 [*]	01941	164	119	45	B
400 x 315	300	6	05 06 400 [*]	05330	206	163	42	B

* Distributed product

* Producto comercializado

¹ AFNOR

² KIWA

³ AENOR

UP. 09. SMF - CONICAL REDUCER

Conical reducer

- Male x female solvent socket
- Metric series

Reducción cónica

- Encolar macho x hembra
- Serie métrica

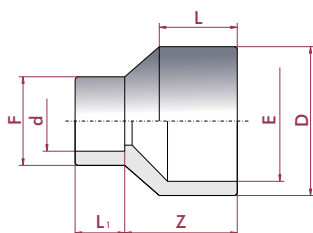

D-E x d	DN	PN	DN	CODE	L	L ₁	Z	F
32-25 x 25	20	16	05 09 032 ³	01974	22	19	30	33
32-25 x 20	15	16	05 09 033 ³	01975	22	16	30	27
40-32 x 32	25	16	05 09 040 ³	01976	26	22	36	38
40-32 x 25	20	16	05 09 041 ³	01977	26	19	36	33
40-32 x 20	15	16	05 09 042 ³	01978	26	16	36	27
50-40 x 40	32	16	05 09 050 ³	01979	31	26	44	48
50-40 x 32	25	16	05 09 051 ³	01980	31	22	44	41
50-40 x 25	20	16	05 09 052 ³	01981	31	19	44	33
50-40 x 20	15	16	05 09 053 ³	01982	31	16	44	27
63-50 x 50	40	16	05 09 063 ³	01983	38	31	54	61
63-50 x 40	32	16	05 09 064 ³	01984	38	26	54	50
63-50 x 32	25	16	05 09 065 ³	01985	38	22	54	41
63-50 x 25	20	16	05 09 066 ³	01986	38	19	54	33
63-50 x 20	15	16	05 09 067 ³	01987	38	16	54	27
75-63 x 63	50	16	05 09 075 ³	01988	44	38	62	73
75-63 x 50	40	16	05 09 076 ³	01989	44	31	62	61
75-63 x 40	32	16	05 09 077 ³	01990	44	26	62	50
75-63 x 32	25	16	05 09 078 ³	01991	44	22	62	41
90-75 x 75	65	16	05 09 090 ³	01992	51	44	74	87
90-75 x 63	50	16	05 09 091 ³	01993	51	38	74	75
90-75 x 50	40	16	05 09 092 ³	01994	51	31	74	61
90-75 x 40	32	16	05 09 093 ³	01995	51	26	74	50
110-90 x 90	80	16	05 09 110 ³	01996	61	51	88	105
110-90 x 75	65	16	05 09 111 ³	01997	61	44	88	90
110-90 x 63	50	16	05 09 112 ³	01998	61	38	88	75
110-90 x 50	40	16	05 09 113 ³	01999	61	31	88	61
125-110 x 90	80	16	05 09 126 ³	02000	69	51	100	105
125-110 x 75	65	16	05 09 127 ³	02001	69	44	100	90
125-110 x 63	50	16	05 09 128 ³	02002	69	38	100	75
140-125 x 110	100	16	05 09 141 ³	02003	76	61	111	130
140-125 x 90	80	16	05 09 142 ³	02004	76	51	111	105
140-125 x 75	65	16	05 09 143 ³	02005	76	44	111	90
160-140 x 125	110	10	05 09 161 ¹³	02006	86	69	126	148
160-140 x 110	100	10	05 09 162 ¹³	02007	86	61	126	130
160-140 x 90	80	10	05 09 163 ³	02008	86	51	126	105
200-180 x 140	125	10	05 09 202	02009	106	76	154	157
200-180 x 125	110	10	05 09 203	02010	106	69	154	140
200-180 x 110	100	10	05 09 204	02011	106	61	154	130
225-200 x 160	150	10	05 09 227	02012	119	86	171	180
225-200 x 140	125	10	05 09 228	02013	119	76	171	160
225-200 x 125	110	10	05 09 229	02014	119	69	171	140
250-225 x 200	175	10	05 09 251	02015	131	106	194	225
250-225 x 160	150	10	05 09 253	02016	131	86	194	180
250-225 x 140	125	10	05 09 254	02017	131	76	194	157
315-280 x 200	175	6	05 09 318 [*]	02018	164	106	233	225
315-280 x 160	150	6	05 09 320 [*]	02019	164	86	233	180

UP. 09. SF - EXCENTRIC CONICAL REDUCER

Excentric conical reducer

- Female solvent socket
- Metric series

Reducción cónica excéntrica

- Encolar hembra
- Serie métrica

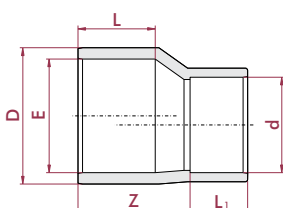

D-E x d	DN	PN	REF.	CODE	L	L ₁	Z
90 - 75 x 63	50	16	05 09 691	09030	51	38	74

* Distributed product
* Producto comercializado

¹ AFNOR
² KIWA
³ AENOR

PVC-U CAPS TAPONES PVC-U

UP. 07. SF - CAP

Cap

- Female solvent socket
- Metric series

Tapón

- Encolar hembra
- Serie métrica

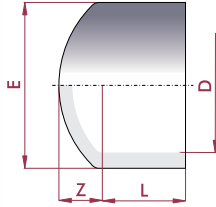

D	DN	PN	REF.	CODE
16	10	16	05 07 016	01942
20	15	16	05 07 020 ²	01943
25	20	16	05 07 025 ²	01944
32	25	16	05 07 032 ²	01945
40	32	16	05 07 040 ²	01946
50	40	16	05 07 050 ²	01947
63	50	16	05 07 063 ²	01948
75	65	16	05 07 075 ²	01949
90	80	16	05 07 090 ²	01950
110	100	16	05 07 110	01951
125	110	16	05 07 125	01952
140	125	16	05 07 140	01953
160	150	10	05 07 160	01954
200	175	10	05 07 200	01955
225	200	10	05 07 225	01956
250	225	10	05 07 250	15776
315	300	10	05 07 315	15777

L	Z	E
14	7	22
16	8	25
19	9	32
22	10	40
26	12	50
31	15	63
38	17	75
44	19	90
51	23	110
61	28	131
69	32	148
76	36	163
86	40	185
106	46	224
119	50	252
131	60	282
164	70	357

UP. 07. FT - CAP

Cap

- BSP female thread

Tapón

- Roscar hembra BSP

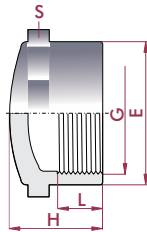

G	DN	PN	REF.	CODE
3/8"	10	10	05 07 616	01957
1/2"	15	10	05 07 620	01958
3/4"	20	10	05 07 625	01959
1"	25	10	05 07 632	01960
1 1/4"	32	10	05 07 640	01961
1 1/2"	40	10	05 07 650	01962
2"	50	10	05 07 663	01963
2 1/2"	65	10	05 07 675	01964
3"	80	10	05 07 690	01965
4"	100	10	05 07 710	01966

L	E	H	S
14	24	20	24
14	27	23	27
16	33	28	33
19	41	33	41
20	50	36	50
20	61	43	61
24	75	50	75
44	90	64	90
51	108	76	108
61	135	91	135

UP. 19. MT - PLUG

Plug

- BSP male thread

Tapón

- Roscar macho BSP

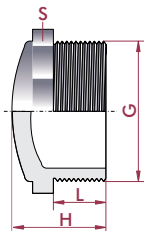

G	DN	PN	REF.	CODE
1/4"	8	10	05 19 612	02121
3/8"	10	10	05 19 616	02122
1/2"	15	10	05 19 620	02123
3/4"	20	10	05 19 625	02124
1"	25	10	05 19 632	02125
1 1/4"	32	10	05 19 640	02126
1 1/2"	40	10	05 19 650	02127
2"	50	10	05 19 663	02128
2 1/2"	65	10	05 19 675	02129
3"	80	10	05 19 690	02130
4"	100	10	05 19 710	02131

L	H	S
10	18	12
10	22	20
14	27	27
16	30	32
19	34	36
21	36	46
21	37	55
26	42	65
30	50	80
33	59	93
38	68	115

¹ AFNOR

² KIWA

³ AENOR

PVC-U NIPPLES MACHONES PVC-U

UP. 15. SFMT - ADAPTOR NIPPLE

Adaptor nipple

- Female solvent socket & BSP male thread
- Metric series

Machón mixto

- Encolar hembra y roscar macho BSP
- Serie métrica

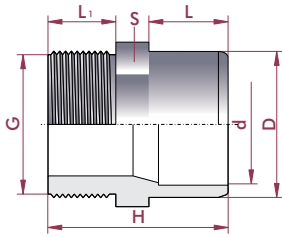

D - d x G	DN	PN	REF.	CODE
16 - 12 x 3/8"	12	10	05 15 416	02073
20 - 16 x 1/2"	15	10	05 15 420	02074
20 - 16 x 3/4"	12	10	05 15 421	02075
25 - 20 x 3/4"	20	10	05 15 425	02076
25 - 20 x 1/2"	15	10	05 15 426	02077
25 - 20 x 3/8"	12	10	05 15 427	02078
32 - 25 x 1"	25	10	05 15 432	02079
32 - 25 x 3/4"	20	10	05 15 433	02080
32 - 25 x 1/2"	15	10	05 15 434	02081
40 - 32 x 1 1/4"	32	10	05 15 440	02082
40 - 32 x 1"	25	10	05 15 441	02083
40 - 32 x 3/4"	20	10	05 15 442	02084
50 - 40 x 1 1/2"	40	10	05 15 450	02085
50 - 40 x 1 1/4"	32	10	05 15 451	02086
50 - 40 x 1"	25	10	05 15 452	02087
63 - 50 x 2"	50	10	05 15 463	02088
63 - 50 x 1 1/2"	40	10	05 15 464	02089
63 - 50 x 1 1/4"	32	10	05 15 465	02090
75 - 63 x 2 1/2"	65	10	05 15 475	02091
75 - 63 x 2"	50	10	05 15 476	02092
75 - 63 x 1 1/2"	40	10	05 15 477	02093
90 - 75 x 3"	80	10	05 15 490	02094
90 - 75 x 2 1/2"	65	10	05 15 491	02095
90 - 75 x 2"	50	10	05 15 492	02096
110 - 90 x 4"	100	10	05 15 510	02097
110 - 90 x 3"	80	10	05 15 511	02098
110 - 90 x 2 1/2"	65	10	05 15 512	02099

L	L ₁	H	S
14	11	35	24
16	14	42	27
16	11	39	27
19	16	47	32
19	14	45	32
19	11	42	32
22	19	54	36
22	16	51	36
22	14	49	36
26	21	60	46
26	19	58	46
26	16	55	46
31	25	70	55
31	21	66	55
31	19	64	55
38	25	78	65
38	21	73	65
38	21	73	65
44	30	89	78
44	25	84	78
44	21	80	78
51	33	99	93
51	30	96	93
51	25	91	93
61	40	116	120
61	33	109	120
61	30	106	120

UP. 16. SFMT - ADAPTOR NIPPLE

Adaptor nipple

- Female solvent socket x BSP male thread
- Metric series

Manguito adaptación

- Encolar hembra x roscar macho BSP
- Serie métrica

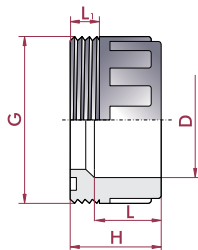

D x G	DN	PN	REF.	CODE
50 x 2"	40	10	05 16 450	02100
63 x 2 1/2"	50	10	05 16 463	02101

L	L ₁	H
31	16	52
38	17	62

UP. 17. SFMT - ADAPTOR BUSH

Adaptor bush

- Female solvent socket x BSP male threaded
- Metric series

Terminal rosca macho

- Encolar hembra x roscar macho BSP
- Serie métrica

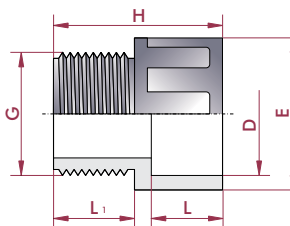

D x G	DN	PN	REF.	CODE
20 x 1/2"	15	10	05 17 420	02102
25 x 3/4"	20	10	05 17 425	02103
32 x 1"	25	10	05 17 432	02104
40 x 1 1/4"	32	10	05 17 440	02105
50 x 1 1/2"	40	10	05 17 450	02106
63 x 2"	50	10	05 17 463	02107
75 x 2 1/2"	65	10	05 17 475	02108
90 x 3"	80	10	05 17 490	02109
110 x 4"	100	10	05 17 510	02110

L	L ₁	E	H
16	14	28	38
19	16	34	42
22	19	41	50
26	21	51	55
31	22	62	65
38	27	77	75
44	30	90	85
51	33	108	98
61	40	131	115

UP. 18. MT - THREADED NIPPLE

Hexagon nipple

- BSP male thread

Machón doble rosca

- Roscar macho BSP

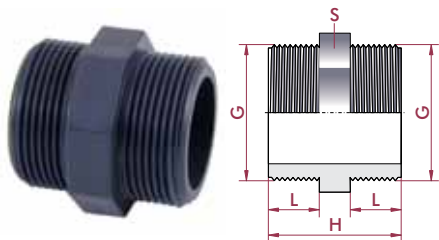

G	DN	PN	REF.	CODE
3/8"	10	10	05 18 616	02111
1/2"	15	10	05 18 620	02112
3/4"	20	10	05 18 625	02113
1"	25	10	05 18 632	02114
1 1/4"	32	10	05 18 640	02115
1 1/2"	40	10	05 18 650	02116
2"	50	10	05 18 663	02117
2 1/2"	65	10	05 18 675	02118
3"	80	10	05 18 690	02119
4"	100	10	05 18 710	02120

L	H	S
11	32	20
14	40	27
16	44	32
19	51	36
21	55	46
21	56	55
26	66	65
30	75	90
33	81	108
38	91	135

UP. 31. SFT - ADAPTOR NIPPLE

Adaptor nipple

- Female solvent socket & BSP female thread

- Metric series

Adaptador mixto

- Encolar hembra y rosca hembra BSP

- Serie métrica

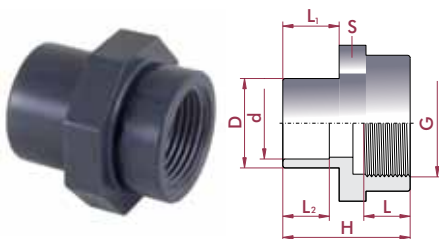

D - d x G	DN	PN	REF.	CODE
20 - 16 x 3/4"	16	10	05 31 420	02243
20 - 16 x 1/2"	16	10	05 31 421	02244
20 - 16 x 3/8"	12	10	05 31 422	02245
20 - 16 x 1/4"	12	10	05 31 423	02246
25 - 20 x 1"	20	10	05 31 425	02247
25 - 20 x 3/4"	20	10	05 31 426	02248
25 - 20 x 1/2"	16	10	05 31 427	02249
32 - 25 x 1 1/4"	25	10	05 31 432	02250
32 - 25 x 1"	25	10	05 31 433	02251
32 - 25 x 3/4"	20	10	05 31 434	02252
32 - 25 x 1/2"	16	10	05 31 435	24822
40 - 32 x 1 1/2"	32	10	05 31 440	02253
40 - 32 x 1 1/4"	32	10	05 31 441	02254
40 - 32 x 1"	25	10	05 31 442	02255
50 - 40 x 2"	40	10	05 31 450	02256
50 - 40 x 1 1/2"	40	10	05 31 451	02257
50 - 40 x 1 1/4"	32	10	05 31 452	02258
63 - 50 x 2 1/2"	50	10	05 31 463	02259
63 - 50 x 2"	50	10	05 31 464	02260
63 - 50 x 1 1/2"	40	10	05 31 465	02261
75 - 63 x 3"	50	10	05 31 475	02262
75 - 63 x 2 1/2"	65	10	05 31 476	02263
75 - 63 x 2"	50	10	05 31 477	02264
90 - 75 x 4"	65	10	05 31 490	02265
90 - 75 x 3"	65	10	05 31 491	02266
90 - 75 x 2 1/2"	65	10	05 31 492	02267
110 - 90 x 4"	80	10	05 31 511	02268
110 - 90 x 3"	80	10	05 31 512	02269

L	L ₁	L ₂	H	S
19	16	14	44	32
18	16	14	43	32
14	16	14	39	32
12	16	14	37	32
22	19	16	50	36
19	19	16	47	32
18	19	16	46	32
25	22	19	56	46
22	22	19	53	36
19	22	19	50	36
18	22	19	49	36
25	26	22	60	55
25	26	22	60	46
22	26	22	57	46
29	31	26	69	65
25	31	26	65	55
25	31	26	65	55
34	38	31	81	78
29	38	31	76	65
25	38	31	72	65
37	44	38	96	108
34	44	38	87	78
29	44	38	82	78
42	51	44	124	135
36	51	44	98	108
33	51	44	92	90
42	61	51	116	135
36	61	51	105	110

UP. 24. SF - SPIGOT CONNECTION

Spigot connection

- Solvent socket

Espiga conexión a PE lisa

- Encolar

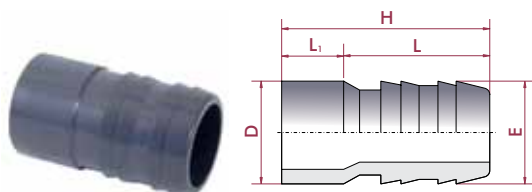

D x E	DN	PN	REF.	CODE
16 x 16	10	10	05 24 016	02200
20 x 18	15	10	05 24 018	02201
20 x 20	15	10	05 24 020	02202
25 x 25	20	10	05 24 025	02203
32 x 30	25	10	05 24 032	02204
40 x 40	32	10	05 24 040	02205
50 x 50	40	10	05 24 050	02206
50 x 38	40	10	05 24 051	02207
63 x 60	50	10	05 24 063	02208

H	L ₁	L	E
49	14	35	16
51	16	35	18
54	16	38	20
61	19	42	25
69	22	47	30
78	26	52	40
88	31	57	50
88	31	57	38
98	38	60	61

UP. 24. MT - SPIGOT CONNECTION

Spigot connection
• BSP male thread

Espiga conexión PE roscada
• Roscar macho BSP

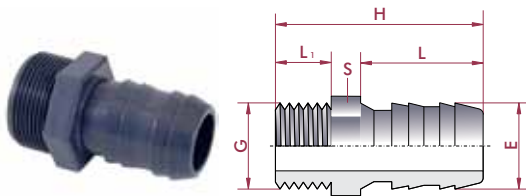

G x E	DN	PN	REF.	CODE
3/8" x 16	10	10	05 24 616	02217
1/2" x 18	15	10	05 24 618	02218
1/2" x 20	15	10	05 24 620	02219
3/4" x 25	20	10	05 24 625	02220
3/4" x 20	20	10	05 24 626	15763
1" x 30	25	10	05 24 632	02221
1" x 25	25	10	05 24 633	09031
1 1/4" x 40	32	10	05 24 640	02222
1 1/2" x 50	40	10	05 24 650	02223
1 1/2" x 38	40	10	05 24 651	02224
1 1/2" x 40	40	10	05 24 652	09032
2" x 60	50	10	05 24 663	02225

H	L ₁	S	L	E
54	11	35	18	16
58	15	35	22	18
60	15	38	22	20
67	17	42	27	25
62	17	36	27	20
78	21	47	36	30
78	21	47	36	25
84	22	52	46	40
89	22	57	50	50
89	22	57	50	38
89	22	57	50	40
100	26	60	65	61

UP. 32. MFT - THREADED REDUCER

Threaded reducer
• BSP male x female thread

Reducción roscada
• Roscar macho x hembra BSP

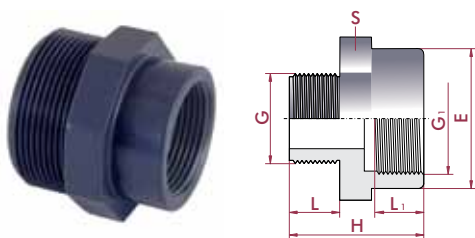

G x G ₁	DN	PN	REF.	CODE
3/8" x 1/2"	10	10	05 32 616	02270
1/2" x 3/4"	15	10	05 32 620	02271
1/2" x 3/8"	10	10	05 32 621	02272
3/4" x 1"	20	10	05 32 625	02273
3/4" x 1/2"	15	10	05 32 626	02274
3/4" x 3/8"	10	10	05 32 627	02275
1" x 1 1/4"	25	10	05 32 632	02276
1" x 3/4"	20	10	05 32 633	02277
1" x 1/2"	15	10	05 32 634	02278
1" x 3/8"	10	10	05 32 635	02279
1 1/4" x 1 1/2"	32	10	05 32 640	02280
1 1/4" x 1"	25	10	05 32 641	02281
1 1/4" x 3/4"	20	10	05 32 642	02282
1 1/4" x 1/2"	15	10	05 32 643	02283
1 1/2" x 2"	40	10	05 32 650	02284
1 1/2" x 1 1/4"	32	10	05 32 651	02285
1 1/2" x 1"	25	10	05 32 652	02286
1 1/2" x 3/4"	20	10	05 32 653	02287
2" x 2 1/2"	50	10	05 32 663	02288
2" x 1 1/2"	40	10	05 32 664	02289
2" x 1 1/4"	32	10	05 32 665	02290
2" x 1"	25	10	05 32 666	02291
2 1/2" x 3"	65	10	05 32 675	02292
2 1/2" x 2"	50	10	05 32 676	02293
2 1/2" x 1 1/2"	40	10	05 32 677	02294
2 1/2" x 1 1/4"	32	10	05 32 678	02295
3" x 4"	80	10	05 32 690	02296
3" x 2 1/2"	63	10	05 32 691	02297
3" x 2"	50	10	05 32 692	02298
3" x 1 1/2"	40	10	05 32 693	02299
4" x 3"	80	10	05 32 711	02300
4" x 2 1/2"	65	10	05 32 712	23001
4" x 2"	50	10	05 32 713	23002

L	L ₁	H	E	S
11	18	42	28	27
15	19	49	35	33
15	14	38	22	22
16	22	46	41	41
16	18	43	28	32
16	14	39	22	33
19	25	53	50	50
19	19	48	33	36
19	18	47	28	36
19	14	43	22	36
21	25	54	61	61
21	25	52	41	46
21	22	50	33	46
21	18	49	28	46
21	29	60	75	75
21	25	55	50	55
21	22	53	41	55
21	19	51	33	55
25	34	68	90	90
25	25	59	61	65
25	25	59	50	65
25	22	57	41	65
30	37	99	108	108
30	29	68	75	80
30	25	64	61	80
30	25	64	50	80
33	43	115	135	135
33	34	75	90	93
33	29	70	75	93
33	25	66	61	93
39	37	91	108	115
39	34	93	90	115
39	29	100	75	115

UP. 33. MT - THREADED REDUCER

Threaded reducer

• BSP male x male thread

Reducción roscada

• Roscar macho x macho BSP

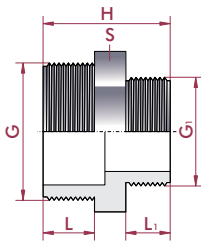

G x G ₁	DN	PN	REF.	CODE
1/2" x 3/8"	10	10	05 33 620	02303
3/4" x 1/2"	15	10	05 33 625	02304
3/4" x 3/8"	10	10	05 33 626	02305
1" x 3/4"	20	10	05 33 632	02306
1" x 1/2"	15	10	05 33 633	02307
1" x 3/8"	10	10	05 33 634	02308
1 1/4" x 1"	25	10	05 33 640	02309
1 1/4" x 3/4"	20	10	05 33 641	02310
1 1/4" x 1/2"	15	10	05 33 642	02311
1 1/2" x 1 1/4"	32	10	05 33 650	02312
1 1/2" x 1"	25	10	05 33 651	02313
1 1/2" x 3/4"	20	10	05 33 652	02314
2" x 1 1/2"	40	10	05 33 663	02315
2" x 1 1/4"	32	10	05 33 664	02316
2" x 1"	25	10	05 33 665	02317
2 1/2" x 2"	50	10	05 33 675	02318
2 1/2" x 1 1/2"	40	10	05 33 676	02319
2 1/2" x 1 1/4"	32	10	05 33 677	02320
3" x 2 1/2"	65	10	05 33 690	02321
3" x 2"	50	10	05 33 691	02322
3" x 1 1/2"	40	10	05 33 692	02323
4" x 3"	80	10	05 33 710	02324
4" x 2 1/2"	65	10	05 33 711	02325
4" x 2"	50	10	05 33 712	02326

L	L ₁	H	S
15	11	36	24
16	15	43	32
16	11	39	32
19	16	48	40
19	15	47	40
19	11	43	40
21	19	53	50
21	16	50	50
21	15	49	50
21	21	56	55
21	19	54	55
21	16	51	55
25	21	61	65
25	21	61	65
25	19	58	65
30	25	70	80
30	21	66	80
30	21	66	80
33	30	78	93
33	25	73	93
33	21	69	93
38	33	86	115
38	30	83	115
38	25	78	115

UP. 34. MFT - SHORT THREADED REDUCER

Short threaded reducer

• BSP male x female thread

Reducción roscada corta

• Roscar macho x hembra BSP

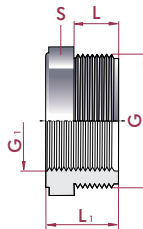

G x G ₁	DN	PN	REF.	CODE
1/2" x 1/4"	7	10	05 34 621	23087
3/4" x 1/2"	15	10	05 34 625	20147
3/4" x 1/4"	7	10	05 34 627	23088
3/4" x 1/8"	3	10	05 34 628	28081
1" x 3/4"	20	10	05 34 632	20148
1" x 1/4"	7	10	05 34 635	23089
1 1/4" x 1"	25	10	05 34 640	20149
1 1/2" x 1 1/4"	32	10	05 34 650	20150
2" x 1 1/2"	40	10	05 34 663	20151
2 1/2" x 2"	50	10	05 34 675	20152
3" x 2 1/2"	63	10	05 34 690	20153
4" x 3"	75	10	05 34 710	20154

L	L ₁	S
14	12	27
16	30	32
16	12	32
16	34	32
19	34	36
12	19	36
21	36	46
21	36	55
26	42	65
30	47	80
33	51	93
39	64	120

PVC-U RUBBER-RING JOINT FITTINGS

ACCESORIOS EN PVC-U CON JUNTA ELÁSTICA

FEATURES

Easy installation fittings, without effort or tools, thanks to its gaskets.
 It is compulsory the use of an inner gasket to install it.
 Designed to support earth movements or misalignments, ideally suited for underground installations.

It can absorb vibrations or pipe expansions due to its elasticity and flexibility.
 To make the installation easier, it is very important to lubricate the gasket correctly.

- Material: PVC-U.
- Density: 1,4 g/cm³.
- Color: grey RAL 7011.
- Dimensions: from D63 to D315.
- Standards: dimensions and characteristics according to EN 1452.

CARACTERÍSTICAS

Accesorios fáciles de instalar, sin esfuerzo y sin herramientas gracias a las juntas.
 Para su correcta instalación es necesaria la junta interior.
 Está realizado para poder soportar movimientos de tierra y desalineaciones, ideal para instalaciones enterradas.

Gracias a su elasticidad y flexibilidad, absorbe mejor las vibraciones y la expansión del tubo.
 Es muy importante una buena lubricación de la junta para instalar el tubo cómodamente.

- Material: PVC-U.
- Densidad: 1,4 g/cm³.
- Color: gris RAL 7011.
- Dimensiones: de D63 hasta D315.
- Normas: dimensiones y características según la norma EN 1452.

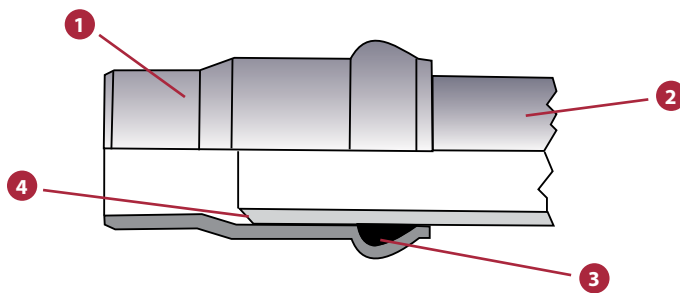

FIG.	Parts	Despiece	Material
1	Union socket	Manguito unión	PVC-U
2	Pipe	Tubería	-
3	Gasket	Junta	NBR
4	Chamfer to make an easier installation	Chaflán para una inserción más fácil	-

TECHNICAL CHARACTERISTICS

Working pressure at 20°C (73°F) water temperature:
 • D63 - D315: PN 10 (150 psi)

CARACTERÍSTICAS TÉCNICAS

Presión de servicio a 20°C (73°F) temperatura de agua:
 • D63 - D315: PN 10 (150 psi)

**PRESSURE / TEMPERATURE GRAPH
 DIAGRAMA PRESIÓN / TEMPERATURA**

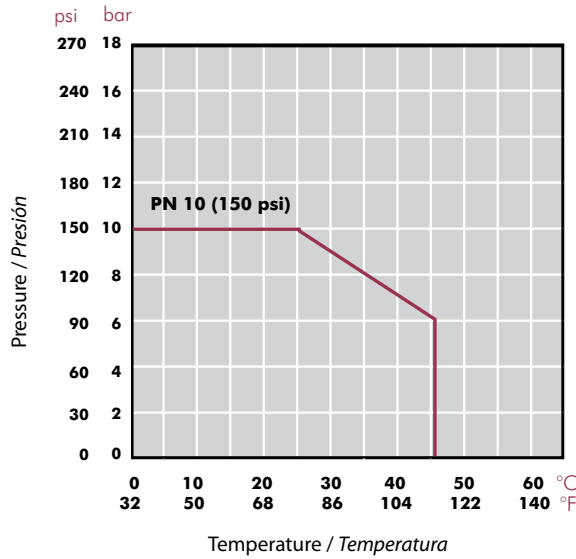

Life: 20 years
 Hydrostatic maximum pressure a component may withstand in continuous service (without overpressure)

Vida útil: 20 años
Presión hidrostática máxima que un componente es capaz de soportar en servicio continuo (sin sobrepresión)

ASSEMBLY

A. Before assembling rubber ring fittings proceed as follows. In case of pipe end damaged: cut the pipe with a proper tool to obtain a square end.

MONTAJE

A. Antes de instalar los accesorios de junta elástica, proceda de la siguiente manera. En caso que el extremo del tubo está dañado: corte el tubo con una herramienta especial para obtener un corte recto perpendicular al eje.

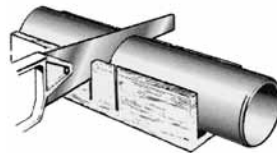

B. Chamfer the pipe with a special tool as shown in the following picture and table.

B. Chafane el tubo con una herramienta especial según lo mostrado en la imagen y el cuadro siguiente.

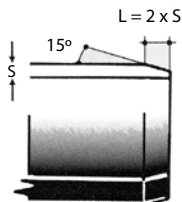

D (mm)	63	75	90	110	125	140	160	200
L (mm)	6,0	7,0	9,0	10,5	12,0	13,5	15,5	19,0

C. Clean carefully the external surface of the pipe and lubricate only with soapy water (do not use oil or grease).

C. Limpie cuidadosamente la superficie externa del tubo. Lubrique solamente con agua jabonosa (no utilice aceite o grasa).

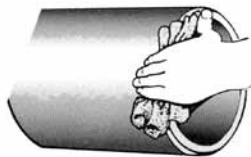

D. Clean carefully the socket seat in the fitting. Check gasket conditions. Introduce the sealing ring into its specific seat.

D. Limpie cuidadosamente el asiento de la junta del accesorio. Compruebe las condiciones de la junta. Introduzca la junta en su asiento específico.



E. Lubricate the internal surface of the rubber ring in the same way as the pipe.

E. Lubrique la superficie interna de la junta con un lubricante adecuado de la misma manera que el tubo.



F. Mark on the outside of the pipe the depth to be inserted into the socket of the fitting according to the lengths in the following table.

F. Marque en el exterior del tubo la profundidad a ser insertada en el accesorio según los longitudes del cuadro.

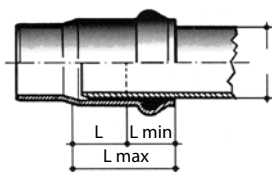

D (mm)	63	75	90	110	125	140	160	200
L max	94	104	109	115	124	133	139	169
L min	42	45	50	55	60	69	75	85
L	52	59	59	60	64	64	64	64

G. To introduce the tube into the fitting we recommend to use the appliance device shown in picture.

- Fix the special assembling device onto the pipe.
- Fix the fitting upon the device.
- With the lever, slide the fitting onto the pipe till you reach the reference mark.

G. Para introducir el tubo en el accesorio se aconseja utilizar un equipo como el mostrado en la imagen.

- Fije un dispositivo de ensamblaje especial sobre el tubo.
- Fije el accesorio sobre el dispositivo.
- Con la palanca, deslice el accesorio sobre el tubo hasta que se alcance la marca de referencia.

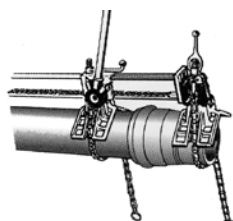

UP. 05. RJ - UNION SOCKET
Union socket

- Rubber ring joint
- Metric series

Manguito unión

- Con junta elástica
- Serie métrica

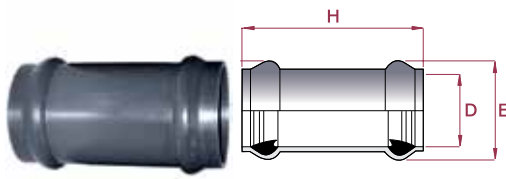

D	DN	PN	REF.	CODE
63	50	10	70 05 063 *	22917
75	65	10	70 05 075 *	22918
90	80	10	70 05 090 *	22919
110	100	10	70 05 110 *	22920
125	110	10	70 05 125 *	22921
140	125	10	70 05 140 *	22922
160	150	10	70 05 160 *	22923
200	175	10	70 05 200 *	22924
225	200	10	70 05 225 *	22925
250	225	10	70 05 250 *	22926
315	300	10	70 05 315 *	22927

E	H
86	380
102	380
120	380
144	380
161	380
178	380
202	380
248	400
277	500
304	500
382	500

* Distributed product
* Producto comercializado

VICTAULIC® COUPLING ENLACE VICTAULIC®

Designed with a heavy housing for high pressure service. The housing key is wider than standard and the coupling housing is designed to clamp the bottom of the groove, thus providing an essentially rigid joint. It also eliminates movement at the joint.

Reduces linear or angular movement and is useful for valve connections and other points where rigidity is required.

Diseñado con una resistente cubierta para soportar altas presiones. La llave es más ancha que las estándares y el enlace está diseñado para agarrar el fondo de la ranura, proporcionando una unión rígida. También está pensado para eliminar los movimientos en la unión.

Reduce el movimiento lineal o angular y se puede usar para conexiones con válvulas o en otros sitios donde se requiera rigidez.

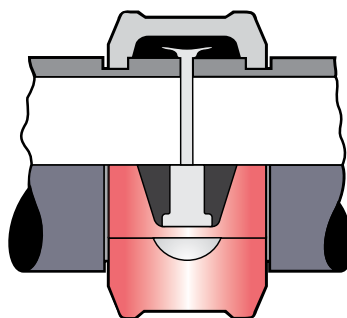

- Fast assembly.
- Allows misalignments up to 1°30'.
- EPDM joint.
- Coupling made of coated ductile iron.
- Bolts made of zinc plated carbon steel.

- Montaje rápido.
- Permite desalineaciones de hasta 1°30'.
- Junta en EPDM.
- Brida en hierro fundido pintado.
- Tornillos en acero zincado.

UP. 58. SFVT - VICTAULIC SOCKET

Victaulic® grooved flexible socket

- Female solvent socket
- Metric series

Enlace Victaulic®

- Encolar hembra
- Serie métrica

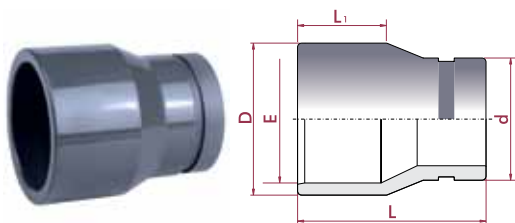

D - E x d	DN	PN	REF.	CODE
75 - 63 x 2"	2"	16	05 58 463	20162
110 - 90 x 3"	3"	16	05 58 490	20163
125 - 110 x 4"	4"	16	05 58 510	20164
180 - 160 x 6"	6"	10	05 58 560	21444

L	L ₁
93	44
132	63
151	71
183	90

UP. 58. VT - VICTAULIC COUPLING

Victaulic® grooved flexible coupling

Brida ranurada Victaulic®

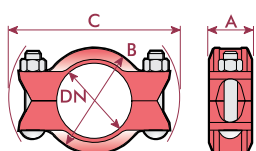

DN	REF.	CODE
2"	05 58 063*	20165
3"	05 58 090*	20166
4"	05 58 110*	20167
6"	05 58 160*	21445

A	B	C
51	89	168
51	121	197
54	152	245
64	219	321

* Distributed product
* Producto comercializado