

FEATURES

- PVC-C fittings for the PVC-C pipe union.
- Material: PVC-U.
- Injection moulding.
- Density: 1,5 g/cm³.
- Color: grey RAL 7042.
- Dimensions: socket fittings D16 to D110 and threaded fittings from ¼" to 4".
- Dimensions:
 - Socket fittings according to EN 1452-3.
 - Threaded fittings according to ISO 7/1.
- For tubes according to EN 1452-2.
- Socket fittings: we recommend solvent cement THF basis.
- Threaded fittings: in order to guarantee the watertightness, PTFE thread-wrap tape must be used. In PVC-U metal unions, use PVC-U as the male.

CARACTERÍSTICAS

- Accesorios en PVC-C para unión de tuberías de PVC-C.
- Moldeo por inyección.
- Densidad: 1,5 g/cm³.
- Color: gris RAL 7042.
- Dimensiones: accesorios encolar de D16 hasta D100 y accesorios roscar de ¼" a 4".
- Dimensiones:
 - Accesorios encolar según la norma EN 1452-3.
 - Accesorios roscados según la norma ISO 7/1.
- Para tubos según norma EN 1452-2.
- Accesorios encolar: recomendamos el uso de cola a base de THF.
- Accesorios roscados: para garantizar la estanqueidad sólo es admisible el uso de cinta de PTFE. En uniones PVC-U-metal, el macho debe ser el PVC-U.

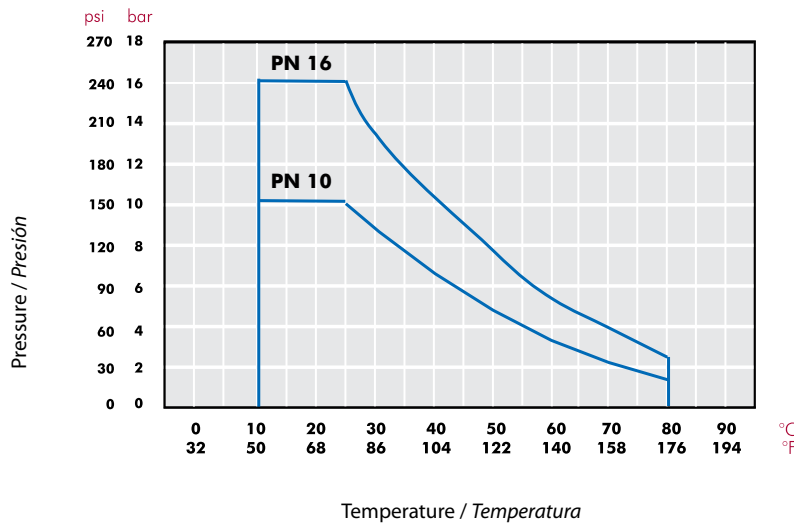

FIG.	Details	Detalles
1	Logo, material, dimensions, PN	Logo, material, dimensiones, PN
2	European standard, N (Aenor), Kiwa o NF (Afnor)	Norma europea, N (Aenor), Kiwa o NF (Afnor)
3	Marked at 45°	Marcaje a 45°

TECHNICAL CHARACTERISTICS
CARACTERÍSTICAS TÉCNICAS

Unions Uniones	Sizes Medidas	Working pressure at 20°C Presión de servicio a 20°C
Solvent socket / Encolar	D16 - D140	PN 16 (240 psi)
Solvent socket / Encolar	D160 - D315	PN10 (150 psi)
Threaded / Roscar	½" - 4"	PN 10 (150 ps)

PRESSURE / TEMPERATURE GRAPH
DIAGRAMA PRESIÓN / TEMPERATURA



Life: 25 years
Hydrostatic maximum pressure a component may withstand in continuous service (without overpressure)

Vida útil: 25 años
Presión hidrostática máxima que un componente es capaz de soportar en servicio continuo (sin sobrepresión)

TOLERANCE GRAPH
DIAGRAMA TOLERANCIAS

(mm x D solvent socket)
EN 1452

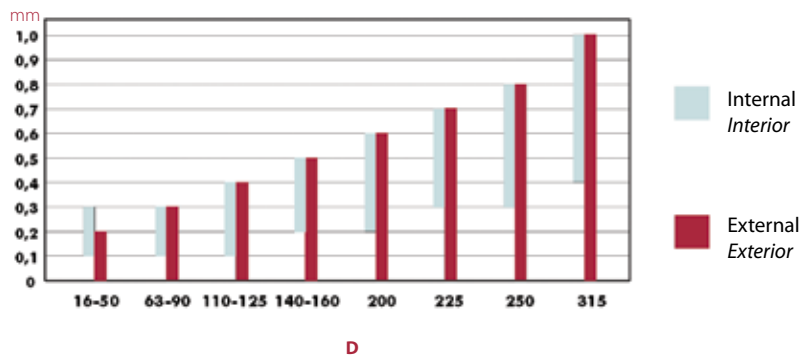

PVC-C ELBOWS CODOS PVC-C

CP. 01. SF - PVC-C 90° ELBOW

90° elbow

- Female solvent socket
- Metric series

Codo 90°

- Encolar hembra
- Serie métrica

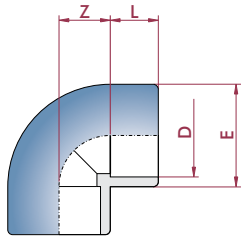

D	DN	PN	REF.	CODE
16	10	16	36 01 016	50692
20	15	16	36 01 020	50693
25	20	16	36 01 025	50694
32	25	16	36 01 032	50695
40	32	16	36 01 040	50696
50	40	16	36 01 050	50697
63	50	16	36 01 063	50698
75	65	16	36 01 075	50699
90	80	16	36 01 090	50700
110	100	16	36 01 110	50701

L	Z	E
17	9	21
21	11	26
26	14	32
31	17	40
36	21	49
42	26	62
51	33	77
43	39	90
50	46	108
60	56	131

CP. 01. SFT - PVC-C 90° ELBOW

90° elbow

- Female solvent socket & male solvent socket
- Metric series

Codo 90°

- Encolar hembra y encolar macho
- Serie métrica

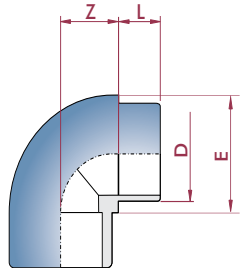

D	DN	PN	REF.	CODE
16	15	16	36 29 216	50788
20	20	16	36 29 220	50789
25	25	16	36 29 225	50790
32	32	16	36 29 232	50791

L	Z	E
17	10	21
21	11	26
26	12	32
31	15	40

CP. 02. SF - PVC-C 45° ELBOW

45° elbow

- Female solvent socket
- Metric series

Codo 45°

- Encolar hembra
- Serie métrica

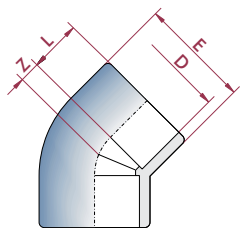

D	DN	PN	REF.	CODE
16	10	16	36 02 016	50702
20	15	16	36 02 020	50703
25	20	16	36 02 025	50704
32	25	16	36 02 032	50705
40	32	16	36 02 040	50706
50	40	16	36 02 050	50707
63	50	16	36 02 063	50708
75	65	16	36 02 075	50709
90	80	16	36 02 090	50710
110	100	16	36 02 110	50711

L	Z	E
17	5	21
21	5	26
26	6	32
31	8	40
36	10	59
42	12	62
51	14	77
43	17	90
50	20	108
60	24	131

CP. 02. SFT - PVC-C 45° ELBOW

45° adaptor elbow

- Female solvent socket & male solvent socket
- Metric series

Codo 45° mixto

- Encolar hembra y encolar macho
- Serie métrica

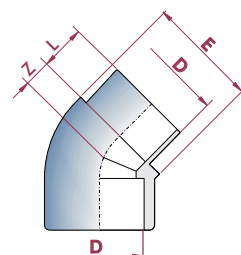

D	DN	PN	REF.	CODE
16	15	10	36 30 216	50792
20	20	10	36 30 220	50793
25	25	10	36 30 225	50794
32	32	10	36 30 232	50795

L	Z	E
17	10	21
21	11	26
26	12	32
31	15	40

PVC-C TEES
TÉS PVC-C

CP. 03. SF - PVC-C TEE

- 90° tee**
- Female solvent socket
 - Metric series

- Té 90°**
- Encolar hembra
 - Serie métrica

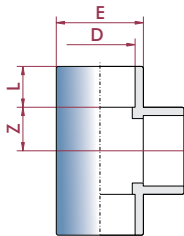

D	DN	PN	REF.	CODE
16	10	16	36 03 016	50712
20	15	16	36 03 020	50713
25	20	16	36 03 025	50714
32	25	16	36 03 032	50715
40	32	16	36 03 040	50716
50	40	16	36 03 050	50717
63	50	16	36 03 063	50718
75	65	16	36 03 075	50719
90	80	16	36 03 090	50720
110	100	16	36 03 110	50721

L	Z	E
17	9	21
21	11	26
26	14	32
31	17	40
36	21	49
41	27	62
51	33	77
43	41	90
50	48	108
60	61	131

CP. 04. SFG - PVC-C TEE

- 90° reducing tee**
- Female solvent socket
 - Metric series

- Té 90° reducida**
- Encolar hembra
 - Serie métrica

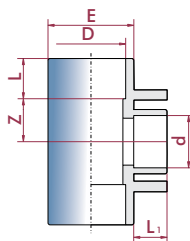

D x d	DN	PN	REF.	CODE
20-16	15-10	16	36 04 020	50722
25-20	20-15	16	36 04 025	50723
32-20	25-15	16	36 04 026	50724
32-25	25-20	16	36 04 032	50725
40-32	32-25	16	36 04 033	50726
50-25	40-20	16	36 04 040	50727
50-40	40-32	16	36 04 050	50728
63-50	50-40	16	36 04 063	50729
63-25	50-20	16	36 04 065	50730
75-40	65-32	16	36 04 077	50731
90-50	80-40	16	36 04 092	50732
110-63	100-50	16	36 04 112	50733

L	L ₁	Z	E
21	18	11	26
26	21	14	32
31	22	17	40
31	26	17	40
35	31	22	49
41	26	27	62
41	36	27	62
48	42	36	77
48	26	36	77
43	36	41	90
50	42	48	108
60	38	61	131

PVC-C SOCKETS
MANGUITOS PVC-C

CP. 05. SF - PVC-C SOCKET

- Socket**
- Female solvent socket
 - Metric series

- Manguito unión**
- Encolar hembra
 - Serie métrica

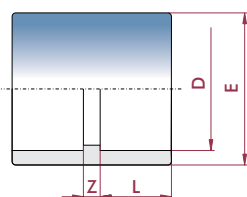

D	DN	PN	REF.	CODE
16	10	16	36 05 016	50734
20	15	16	36 05 020	50735
25	20	16	36 05 025	50736
32	25	16	36 05 032	50737
40	32	16	36 05 040	50738
50	40	16	36 05 050	50739
63	50	16	36 05 063	50740
75	65	16	36 05 075	50741
90	80	16	36 05 090	50742
110	100	16	36 05 110	50743

L	Z	E
17	3	21
21	3	26
26	3	32
31	3	40
36	3	49
42	3	62
51	3	77
43	4	90
50	9	108
60	6	131

CP. 15. SFMT - PVC-C ADAPTOR NIPPLE

Adaptor nipple

- Female solvent socket & BSP male thread
- Metric series

Machón mixto

- Encolar hembra y roscar macho BSP
- Serie métrica

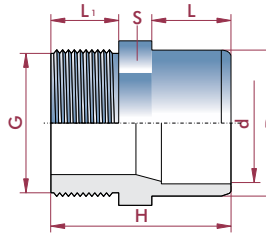

D - d x G	DN	PN	REF.	CODE
32-25 x 3/4"	12	10	36 15 433	50776
32-20 x 3/4"	15	10	36 15 436	50777
32-20 x 1/2"	12	10	36 15 437	50778
32-16 x 1/2"	20	10	36 15 439	50779
40-32 x 1"	15	10	36 15 441	50780
40-25 x 1"	12	10	36 15 444	50781
50-40 x 1 1/4"	25	10	36 15 451	50782
50-32 x 1 1/4"	20	10	36 15 454	50783
63-50 x 1 1/2"	15	10	36 15 464	50784
63-40 x 1 1/2"	32	10	36 15 467	50785
75-63 x 2"	25	10	36 15 476	50786
75-50 x 2"	20	10	36 15 479	50787

L	L ₁	H	S
31	17	61	36
31	17	61	36
31	20	57	36
31	20	57	36
36	19	68	46
36	19	68	46
42	21	78	55
42	21	78	44
51	24	91	65
51	24	91	65
44	31	93	78
44	31	93	78

PVC-C REDUCERS
REDUCCIONES PVC-C

CP. 06. SMF - PVC-C REDUCTION

Reducing bush

- Male x female solvent socket
- Metric series

Casquillo reducción

- Encolar macho x hembra
- Serie métrica

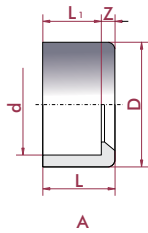

D x d	DN	PN	REF.	CODE
20-16	10	16	06 06 020	50744
25-20	15	16	36 06 025	50745
25-16	10	16	36 06 026	50746
32-25	20	16	36 06 032	50747
32-20	20	16	06 06 033	50748
40-32	25	16	06 06 040	50749
40-25	20	16	36 06 041	50750
50-40	32	16	36 06 050	50751
50-32	25	16	36 06 051	50752
63-50	40	16	36 06 063	50753
63-40	32	16	36 06 064	50754
75-63	50	16	36 06 075	50755
75-50	40	16	36 06 076	50756
90-75	65	16	36 06 090	50757
90-63	50	16	36 06 091	50758
110-90	80	16	36 06 110	50759
110-75	65	16	36 06 111	50760

L	L ₁	Z
21	17	4
26	21	5
26	17	9
31	26	5
31	21	10
36	26	10
42	36	6
42	31	11
52	36	16
43	37	6
43	30	13
50	43	7
60	50	10
60	43	17

PVC-C CAPS
TAPONES PVC-C

CP. 07. SF - PVC-C CAP

Cap

- Female solvent socket
- Metric series

Tapón

- Encolar hembra
- Serie métrica

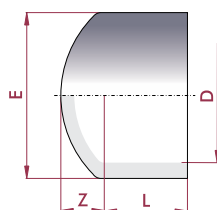

D	DN	PN	REF.	CODE
16	10	16	36 07 016	50761
20	15	16	36 07 020	50762
25	20	16	36 07 025	50763
32	25	16	36 07 032	50764
40	32	16	36 07 040	50765
50	40	16	36 07 050	50766
63	50	16	36 07 063	50767
75	63	16	36 07 075	50768
90	80	16	36 07 090	50769
110	100	16	36 07 110	50800

L	Z	E
17	5	21
26	7	31
31	9	40
36	10	50
51	15	77
43	20	89
50	25	105
60	30	130

PVC-C LOOSE FLANGES BRIDAS LOCAS PVC-C

• EN 1452 Flange System.
• We recommend to follow flange installation instructions carefully to avoid any unnecessary tensions.

• Sistema de bridas EN 1452.
• Recomendamos seguir exactamente las normas de montaje de bridas con objeto de evitar tensiones innecesarias.

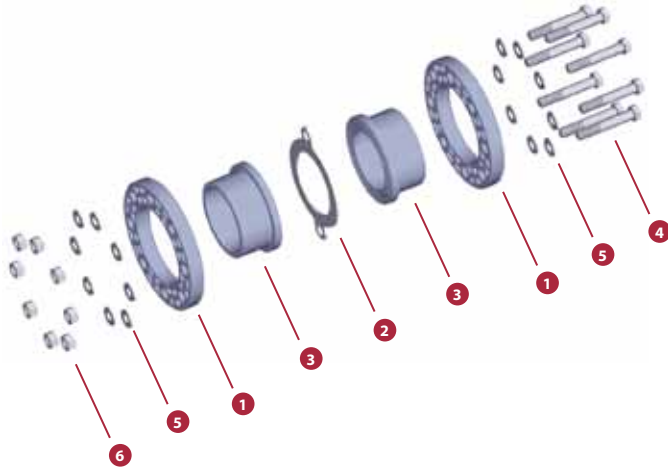

D	2		1	3
	EVA	EPDM	PVC-C	PVC-C
20	✓	✓	✓	✓
25	✓	✓	✓	✓
32	✓	✓	✓	✓
40	✓	✓	✓	✓
50	✓	✓	✓	✓
63	✓	✓	✓	✓
75	✓	✓	✓	✓
90	✓	✓	✓	✓
110	✓	✓	✓	✓

FIG.	Parts	Despiece	Material
1	Flange	Brida	PVC-C
2	Flat gasket	Junta plana	EVA / EPDM
3	Flange adaptor **	Manguito portabridas **	PVC-C
4	Screw DIN 931	Tornillo DIN 931	5.6 Zinc plated steel / A2 Stainless steel *
5	Washer DIN 125-A	Arandela DIN 125-A	
6	Nut DIN 934	Tuerca DIN 934	

* On order A4 Stainless steel
Bajo pedido acero inoxidable A4

** Flange adaptor available in BS and ASTM solvent socket standards
Manguito portabridas disponible en standards BS y ASTM

TIGHTENING SEQUENCE ORDEN DE APRIETE

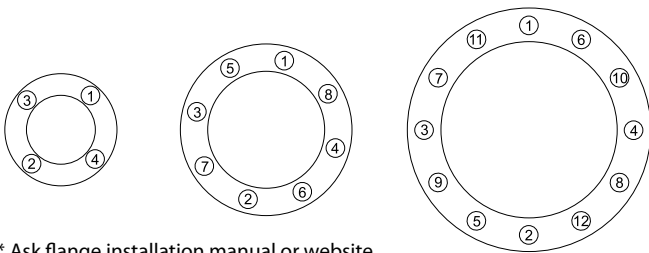

* Ask flange installation manual or website
Consultar manual instalación bridas o website

TIGHTENING MAXIMUM TORQUE MÁXIMO PAR DE APRIETE

D	DN	inch	N · m	Kgf · cm	inch · lbs
63-75	65	2 1/2"	25	255	221
90	80	3"	25	255	221
110	100	4"	30	306	265

CP. 10. SF - PVC-C ADAPTOR FLANGE
Flange adaptor (sub flange)

- Female solvent socket
- Metric series

Manguito portabridas

- Encolar hembra
- Serie métrica

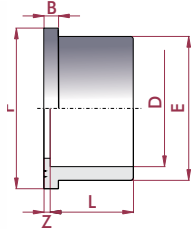

D	DN	PN	REF.	CODE
20	15	16	36 10 020	56810
25	20	16	36 10 025	56811
32	25	16	36 10 032	56812
40	32	16	36 10 040	50770
50	40	16	36 10 050	50771
63	50	16	36 10 063	50772
75	63	16	36 10 075	50773
90	80	16	36 10 090	50774
110	100	16	36 10 110	50775

L	Z	B	E	F
21	3	5	27	30
26	3	6	36	39
21	3	7	41	50
26	5	8	50	61
31	5	8	61	73
37	5	9	76	90
43	6	10	90	106
50	5	11	108	125
60	5	12	131	145

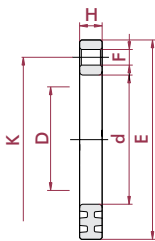
CP. 11. FLG - PVC-C FLANGE
Flange
Brida

D	DN	PN	REF.	CODE
20	15		36 11 020	56245
25	20		36 11 025	56246
32	25		36 11 032	56247
40	32		36 11 040	56248
50	40		36 11 050	56249
63	50		36 11 063	56250
75	65		36 11 075	57714
90	80		36 11 090	57715
110	100		36 11 110	57716

d	E	H	K	F
28	95	12	65	14 x 4
34	105	13	75	14 x 4
42	115	15	85	14 x 4
51	140	16	100	18 x 4
62	150	17	110	18 x 4
78	165	18	125	18 x 4
92	185	22	145	18 x 4
110	200	23	160	18 x 8
133	220	24	180	18 x 8

EVA. 14 - FLAT GASKET
EVA flat gasket

- Metric series

Junta plana EVA

- Serie métrica

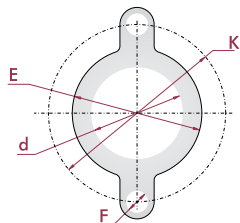

D	DN	REF.	CODE
20	15	05 14 020 *	07700
25	20	05 14 025 *	07701
32	25	05 14 032 *	07702
40	32	05 14 040 *	07703
50	40	05 14 050 *	02061
63	50	05 14 063 *	02062
75	65	05 14 075 *	02063
90	80	05 14 090 *	02064
110	100	05 14 110 *	02065

d	E	H	K	F
20	32	2	65	14
25	39	2	75	14
32	48	2	85	14
40	59	2	100	18
50	71	3	110	18
63	88	3	125	18
75	104	3	145	18
90	123	3	160	18
110	148	4	180	18

PDM. 14 - FLAT GASKET
EPDM flat gasket

- Metric series

Junta plana EPDM

- Serie métrica

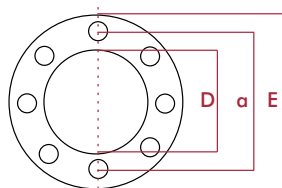

D	DN	REF.	CODE
20	15	05 14 020 EPDM *	66933
25	20	05 14 025 EPDM *	66934
32	25	05 14 032 EPDM *	66935
40	32	05 14 040 EPDM *	66936
50	40	05 14 050 EPDM *	66937
63	50	05 14 063 EPDM *	66938
75	65	05 14 075 EPDM *	66939
90	80	05 14 090 EPDM *	66340
110	100	05 14 110 EPDM *	66941

H	E	a	F
2,5	93	34	16 x 4
2,5	103	41	19 x 4
2,5	115	50	22 x 4
2,5	140	100	20 x 4
2,5	150	110	20 x 4
2,5	165	125	20 x 4
2,5	185	145	20 x 4
2,5	200	160	20 x 8
2,5	220	180	20 x 8

BOLTS TORNILLERÍA

Required bolt size depending on each application of the flange:
butterfly valve, coupling or swing check valve.

Modelo y tamaño necesario de tornillería para cada una de las aplicaciones
de la brida: válvula de mariposa, enlace o válvula de clapeta.



Flange set (loose flange)
Enlace bridas (brida loca)

Industrial ball valve with loose flanges
Válvula de bola Industrial con bridas locas

FLANGE SIZE	SCREW SIZE	UNITS	CODE	CODE
			5.6 zinc plated steel	A2 stainless steel
D20, D25	M12 x 60	4	16061	60515
D32	M12 x 60	4	16061	60515
D40	M12 x 60	4	16061	60515
D50	M16 x 70	4	02437	60516
D63	M16 x 70	4	02437	60516
D75	M16 x 80	4	02438	60517
D90	M16 x 90	8	02439	60518
D110	M16 x 90	8	02439	60518



Flange set (fix flange)
Enlace bridas (brida fija)

FLANGE SIZE	SCREW SIZE	UNITS	CODE	CODE
			5.6 zinc plated steel	A2 stainless steel
D20, D25	M 12 x 60	4	60515	16061
D32	M 12 x 60	4	60515	16061
D40	M 16 x 70	4	60516	02437
D50	M 16 x 70	4	60516	02437
D63	M 16 x 70	4	60516	02437
D75	M 16 x 70	4	60516	02437
D90	M 16 x 70	8	60516	02437
D110	M 16 x 80	8	60517	02438



Butterfly valve (loose flange)
Válvula mariposa (brida loca)

FLANGE SIZE	SCREW SIZE	UNITS	CODE	CODE
			5.6 zinc plated steel	A2 stainless steel
D63	M 16 x 120	4	02440	60519
D75	M 16 x 140	4	02442	60526
D90	M 16 x 150	8	02443	60527
D110	M 16 x 160	8	02444	60528



Butterfly valve (fix flange)
Válvula mariposa (brida fija)

FLANGE SIZE	SCREW SIZE	UNITS	CODE	CODE
			5.6 zinc plated steel	A2 stainless steel
D63	M 16 x 120	4	02440	60519
D75	M 16 x 120	4	02440	60519
D90	M 16 x 130	8	02441	60525
D110	M 16 x 130	8	02441	60625



Swing check valve (loose flange)
Válvula de clapeta (brida loca)

FLANGE SIZE	SCREW SIZE	UNITS	CODE	CODE
			5.6 zinc plated steel	A2 stainless steel
D75	M 16 x 120	4	02440	60519
D90	M 16 x 120	8	02440	60519
D110	M 16 x 120	8	02440	60519

* Valid for Industrial, Standard and Classic Series

* Válido para Serie Industrial, Standard y Classic

CP. 60. SF - PVC-C UNION

Union

- Female solvent socket
- Metric series

Enlace 3 piezas

- Encolar hembra
- Serie métrica



D	DN	PN	REF.	CODE
20	15	16	36 50 020	69610
25	20	16	36 50 025	69611
32	25	16	36 50 032	69612
40	32	16	36 50 040	69613
50	40	16	36 50 050	69614
63	50	16	36 50 063	69615

SOLVENT CEMENT

ADHESIVOS

ATTENTION

- Carry out an accurate turnover of the stock as the solvent cement can lose the original characteristics after 12 months of its manufacture.
- Stock in a dry and fresh place.
- Please, read the instructions of use.
- Different solvent cements for PVC-U and PVC-C (read the description).
- If you want to read the solvent socket recommendations, please refer to Pipe installation Section

ATENCIÓN

- Realizar una correcta rotación del stock ya que el adhesivo puede perder sus características originales a partir de los 12 meses de su fabricación.
- Almacenar en un lugar seco y fresco.
- Ver las normas de utilización del envase.
- Adhesivos diferenciados para PVC-U y PVC-C (ver descripción).
- Para ver las recomendaciones de instalación con adhesivo, consulte la Sección de Instalación de tubería.

Average joints for 1.000 cc of solvent cement
Nº aproximado de encoladuras efectuadas con 1.000 cc de adhesivo

Ø of pipe Ø de tubo	16	20	25	32	40	50	63	75	90	110	125	140	160	200	225	250	315	400
Nº of joints Nº de encoladuras	390	375	300	250	200	110	80	55	40	25	22	18	11	7	5	4	3	2

CP. 90. SCH - PVC-C SOLVENT CEMENT

HT-120 solvent cement PVC-C

Adhesivo HT-120 PVC-C



Size Medida	REF.	CODE
Can with paint brush Bote con pincel	500 cc	36 90 051
		52708

UP. 90. SCH - PVC-C SOLVENT CEMENT

HCR-36 solvent cement PVC-C & PVC-U

Adhesivo HCR-36 PVC-C & PVC-U

- High chemical resistance

- Alta resistencia química



Size Medida	REF.	CODE
Can with paint brush Bote con pincel	500 cc	36 90 051
		52708

Sulphuric acid: concentrations > 70%
 Hydrochloric acid: concentrations > 25%
 Nitric acid: concentrations > 20%
 Lyes (caustic soda): concentrations > 35%
 Fluoric acid: any concentration
 Sodium hypochlorite: active chlorine content > 7.5%