

## PVC-U SWING CHECK VALVES

### VALVOLE A CLAPET PVC-U



Dimensioni	Flange metriche D63 - D315 (DN50 - DN300) ASTM flange 4" - 12"	
Standard	ISO/DIN ASTM - 4" - 12"	EN 558-1 ANSI B.16.5 cl. 150
Pressione di lavoro	@ 20°C (73°F)  D63 - D315 (2" - 12"): PN 6 (90 psi)	
Pressione di ritorno minima	<b>0,2 bar (3 psi)</b> <b>Minimal downstream pressure to keep the valve closed in horizontal position.</b> <b>Pressione minima a valle per conservare la valvola chiusa in caso di installazione orizzontale.</b>	
• Materiale:	O-ring: EPDM / FPM	
Caratteristiche	<ul style="list-style-type: none"> <li>• Requires little space in piping systems.</li> <li>• Easy installation: wafer body slips between standard flanges. <b>No gaskets required.</b></li> <li>• Vertical and horizontal operation.</li> <li>• Excellent flow characteristics.</li> </ul> <p>Do not install the valve at a distance lower than 5 x D of the pump out. Install with pipe DIN PN 10. In case of PN 16, the valve could be damaged.</p>	<ul style="list-style-type: none"> <li>• Richiede poco spazio per l'installazione.</li> <li>• Facile installazione: si monta tra due flange standard. <b>Non richiede guarnizioni.</b></li> <li>• Installazione verticale o orizzontale.</li> <li>• Eccellenti caratteristiche idrauliche.</li> </ul> <p>Non montare la valvola a una distanza inferiore a 5 x D dall'uscita di una pompa. Montare con tubo e flangia DIN PN 10. In caso di utilizzo PN 16 la valvola potrebbe essere danneggiato.</p>
Certificazioni / norme	Norma sul design della valvola di non ritorno - ISO 16137:2006	

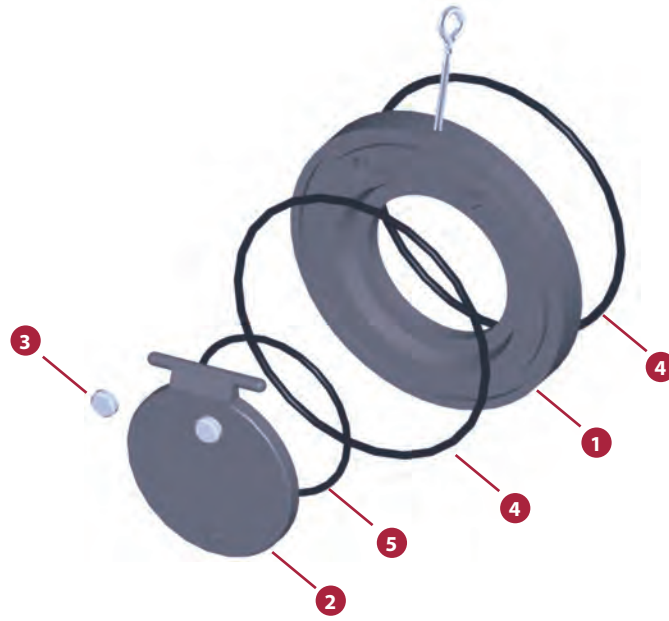
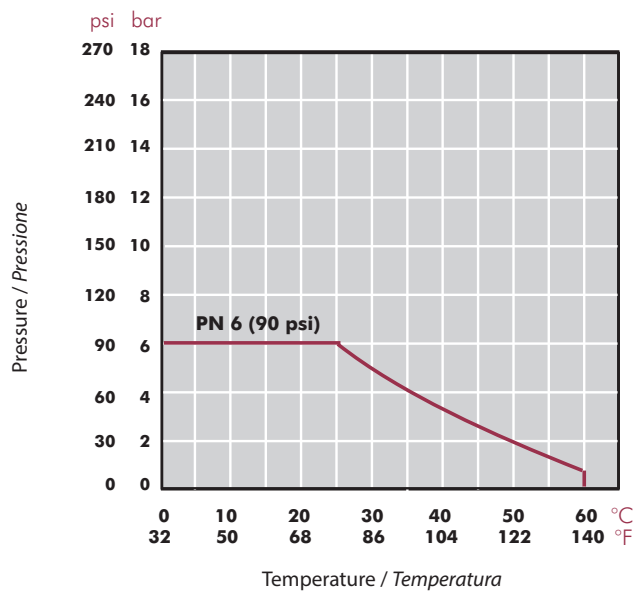

FIG.	Parts	Parti	Materiale
1	Body	Corpo	PVC-U
2	Flap	Clapet	PVC-U
3	Cap	Tappo	PP
4	Body O-ring	O-ring corpo	EPDM / FPM
5	Flap O-ring	O-ring clapet	EPDM / FPM

**PRESSURE / TEMPERATURE GRAPH**  
**DIAGRAMMA PRESSIONE / TEMPERATURA**



Life: 25 years  
 Hydrostatic maximum pressure a component may withstand in continuous service (without overpressure)

*Vita utile: 25 anni*  
*Pressione idrostatica massima considerando la capacità massima di sopportazione in servizio continuo (senza sovrappressione)*

**PRESSURE LOSS DIAGRAM**

**DIAGRAMMA DELLE PERDITE DI CARICO**

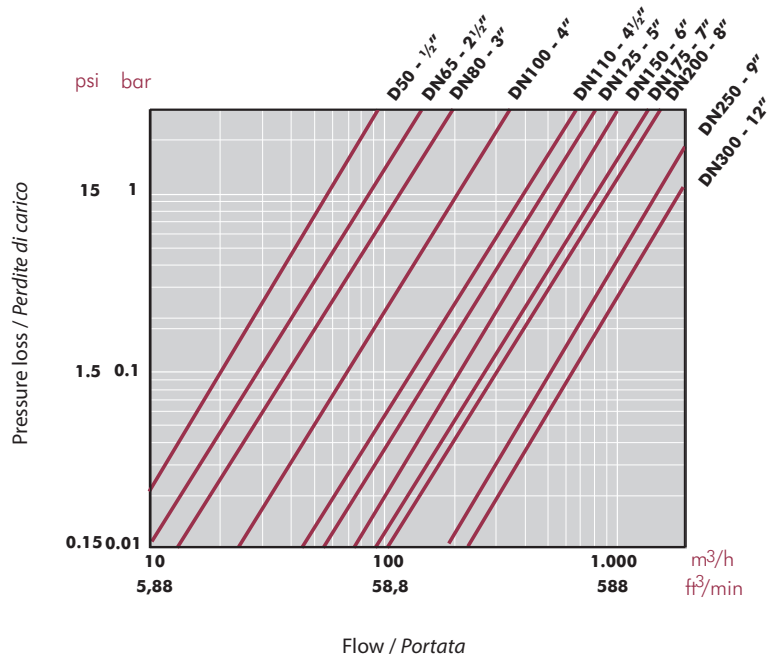

**RELATIVE FLOW**  
**FLUSSO RELATIVO**

<b>D</b>	63	75	90	110	125	140	160	200	225	250	280	315
<b>DN</b>	50	65	80	100	125	125	150	175	200	250	250	300
<b>Kv<sub>100</sub></b>	57	85	130	200	390	480	600	800	900	1.600	1.600	1.850
<b>Cv</b>	4,0	6,0	9,1	14,0	27,3	33,6	42,0	56,0	63,0	112,0	112,0	129,6

$Cv = Kv_{100} / 14,28$   
 $Kv_{100}$  (l/min,  $\Delta p = 1$  bar)  
 $Cv$  (GPM,  $\Delta p = 1$  psi)

## UP. 65 - VALVOLA DI NON RITORNO A CLAPET

### Swing check valve

- PVC-U body
- O-rings in EPDM

### Valvola a clapet

- Corpo in PVC-U
- O-ring in EPDM

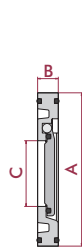
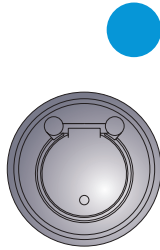

D	DN	PN	RIF.	CODICE
63	50	6	05 65 063 *	<b>37055</b>
75	65	6	05 65 075	<b>08984</b>
90	80	6	05 65 090	<b>08985</b>
110	100	6	05 65 110	<b>08986</b>
125	125	6	05 65 125	<b>09040</b>
140	125	6	05 65 140	<b>08987</b>
160	150	6	05 65 160	<b>08988</b>
200	175	6	05 65 200	<b>09041</b>
225	200	6	05 65 225	<b>08989</b>
250	250	6	05 65 250	<b>37056</b>
280	250	6	05 65 280 *	<b>41865</b>
315	300	6	05 65 315 *	<b>37057</b>

A	B	C
109	20	32
129	20	40
144	20	52
164	22	70
170	25	83
195	23	92
220	25	112
247	28	139
275	35	150
328	40	162
330	40	189
380	45	226

## UP. 65. FG - VALVOLA DI NON RITORNO A CLAPET

### Swing check valve

- PVC-U body
- O-rings in EPDM perox.

### Valvola a clapet

- Corpo in PVC-U
- O-ring in EPDM perox.

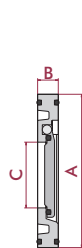
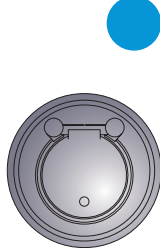

D	DN	PN	RIF.	CODICE
63	50	6	05 65 063 FG *	<b>37055FG</b>
75	65	6	05 65 075 FG	<b>08984FG</b>
90	80	6	05 65 090 FG	<b>08985FG</b>
110	100	6	05 65 110 FG	<b>08986FG</b>
125	125	6	05 65 125 FG	<b>09040FG</b>
140	125	6	05 65 140 FG	<b>08987FG</b>
160	150	6	05 65 160 FG	<b>08988FG</b>
200	175	6	05 65 200 FG	<b>09041FG</b>
225	200	6	05 65 225 FG	<b>08989FG</b>
250	250	6	05 65 250 FG	<b>37056FG</b>
280	250	6	05 65 280 FG*	<b>41865FG</b>
315	300	6	05 65 315 FG*	<b>37057FG</b>

A	B	C
109	20	32
129	20	40
144	20	52
164	22	70
170	25	83
195	23	92
220	25	112
247	28	139
275	35	150
328	40	162
330	40	189
380	45	226

## UP. 65. VIT - VALVOLA DI NON RITORNO A CLAPET

### Swing check valve

- PVC-U body
- O-rings in FPM

### Valvola a clapet

- Corpo in PVC-U
- O-ring in FPM

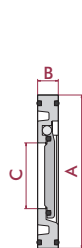
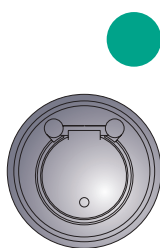

D	DN	PN	RIF.	CODICE
63	50	6	05 65 063 VIT*	<b>37055VI</b>
75	65	6	05 65 075 VIT	<b>08984VI</b>
90	80	6	05 65 090 VIT	<b>08985VI</b>
110	100	6	05 65 110 VIT	<b>08986VI</b>
125	125	6	05 65 125 VIT	<b>09040VI</b>
140	125	6	05 65 140 VIT	<b>08987VI</b>
160	150	6	05 65 160 VIT	<b>08988VI</b>
200	175	6	05 65 200 VIT	<b>09041VI</b>
225	200	6	05 65 225 VIT	<b>08989VI</b>
250	250	6	05 65 250 VIT	<b>37056VI</b>
280	250	6	05 65 280 VIT*	<b>41865VI</b>
315	300	6	05 65 315 VIT*	<b>37057VI</b>

A	B	C
109	20	32
129	20	40
144	20	52
164	22	70
170	25	83
195	23	92
220	25	112
247	28	139
275	35	150
328	40	162
330	40	189
380	45	226

## UP. 65. VKIT - VALVOLA DI NON RITORNO A CLAPET CON KIT

### Swing check valve with mounting kit

- PVC-U body
- O-rings in EPDM
- Loose flanges

### Valvola a clapet con kit accessori

- Corpo in PVC-U
- O-ring in EPDM
- Flangia libera

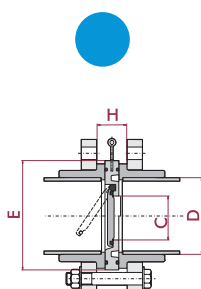

D	DN	PN	RIF.	CODICE
63	50	6	05 65 063 RA *	<b>37073</b>
75	65	6	05 65 075 RA	<b>23312</b>
90	80	6	05 65 090 RA	<b>23313</b>
110	100	6	05 65 110 RA	<b>23314</b>
125	125	6	05 65 125 RA	<b>23315</b>
140	125	6	05 65 140 RA	<b>23316</b>
160	150	6	05 65 160 RA	<b>23317</b>
200	175	6	05 65 200 RA	<b>23318</b>
225	200	6	05 65 225 RA	<b>23319</b>
250	250	6	05 65 250 RA	<b>37074</b>
315	300	6	05 65 315 RA *	<b>37075</b>

C	H
32	26
40	30
52	30
70	32
83	35
92	33
112	37
139	40
150	51
162	56
226	64