

Check Valve - Ball Series

Characteristics

Working pressure at 20°C (73°F) water temperature:

- D20 - D63 (½"-2"): PN 16 bar (240 p.s.i.)
- D75 - D110 (2½"-4"): PN 10 (150 p.s.i.)

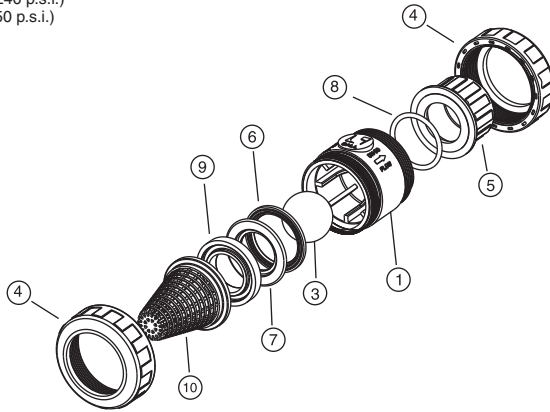

Components

Description	Material
1. Body	PVC / CPVC
3. Ball	PVC / CPVC
4. Union nut	PVC / CPVC
5. End connector	PVC / CPVC
6. Closing ring	PVC / CPVC
7. Body o-ring	EPDM / Viton®
8. End connector o-ring	EPDM / Viton®
9. Seal-carrier	PVC / CPVC
10. Screen	PP

ENGLISH

Assembly Instructions

Solvent socket or threaded unions

Loosen the union nuts (4) and separate these and the end connectors (5) from the valve body. Pass the pipe through the nuts and then place the bushes over the ends of the pipe. The solvent unions should be glued onto the pipe using a PVC adhesive and pressure should not be applied to the system until a drying period of at least 1 hour per 14.5 psi of working pressure has elapsed. In the case of threaded unions, PTFE tape should be applied to the male threads. The pipes can now be attached to the valve by hand tightening down the nuts.

Installation may be vertically and horizontally

WARNING: Minimum return pressure: 0,2 bar (3 psi)

Foot valve

Use the screen instead of the end connector of the fluid entrance to transform the check valve into a foot valve.

Foot valves are a particular type of check valves which are installed on the base of an aspiration pipe of a pump to prevent the impulsion pipe from emptying.

The valve must be installed between the pump and the tank in order to let the fluid access the pump and stopping it when returning to the tank. The entry of the valve is protected by a screen filter to prevent the entry of unwanted elements which could exist in the tank or deposit.

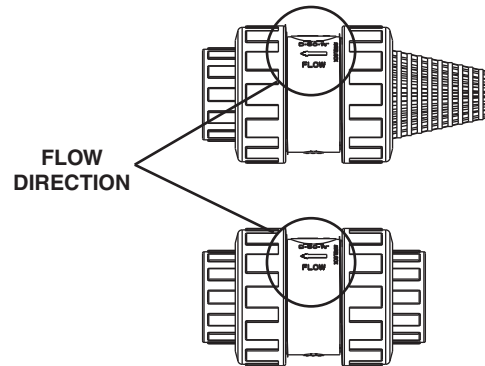

Pressure loss diagram

Check valve

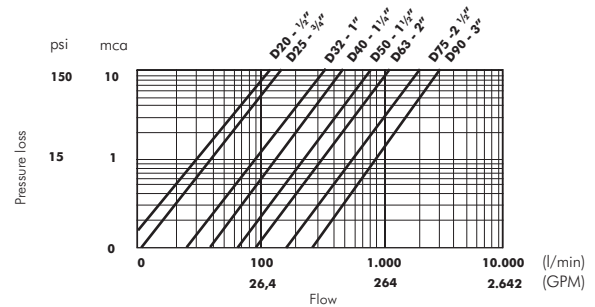

Pressure / temperature diagram

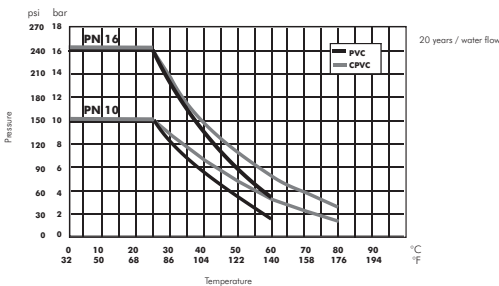

Relative flow chart

	Cv	Kv
D20 - ½"	7	99
D25 - ¾"	9	128
D32 - 1"	22	308
D40 - 1¼"	32	453
D50 - 1½"	56	795
D63 - 2"	73	1040
D75 - 2½"	135	1932
D90 - 3"	193	2754

D20 - ½"		D25 - ¾"		D32 - 1"		D40 - 1¼"		D50 - 1½"		D63 - 2"		D75 - 2½"		D90 - 3"	
A	B	A	B	A	B	A	B	A	B	A	B	A	B	A	B
1.65	0.13	1.47	0.05	4.36	0.08	4.87	0.15	6.41	0.002	12.53	0.05	12.32	0.05	7.13	0.009
2.33	0.24	2.01	0.054	4.89	0.11	6.21	0.17	11.3	0.02	14.9	0.07	14.95	0.06	15.91	0.04
3.34	0.44	2.34	0.09	5.44	0.15	7.52	0.21	18.76	0.16	17.12	0.11	19.53	0.11	28.58	0.13
3.85	0.52	2.95	0.18	5.89	0.21	10.61	0.27	25.05	0.34	21.7	0.16	25	0.17	37.22	0.22
4.52	0.69	3.6	0.29	7.01	0.26	12.53	0.34	28.44	0.41	27.36	0.28	32.6	0.28	45.61	0.53
-	-	4.03	0.36	9.23	0.39	15.23	0.4	-	-	32.02	0.37	41.43	0.55	58.5	0.64
-	-	4.21	0.38	-	-	-	-	-	-	37.68	0.43	-	-	-	-

A= Flow (m³/h)
 B= Pressure loss (bar)

Kv= l/min at 1 bar
 Cv= GPM at 1 psi